

Oliveri®

Builders Collection

KITCHEN / BATHROOM / LAUNDRY

Edition 1.1 / oliveri.com.au

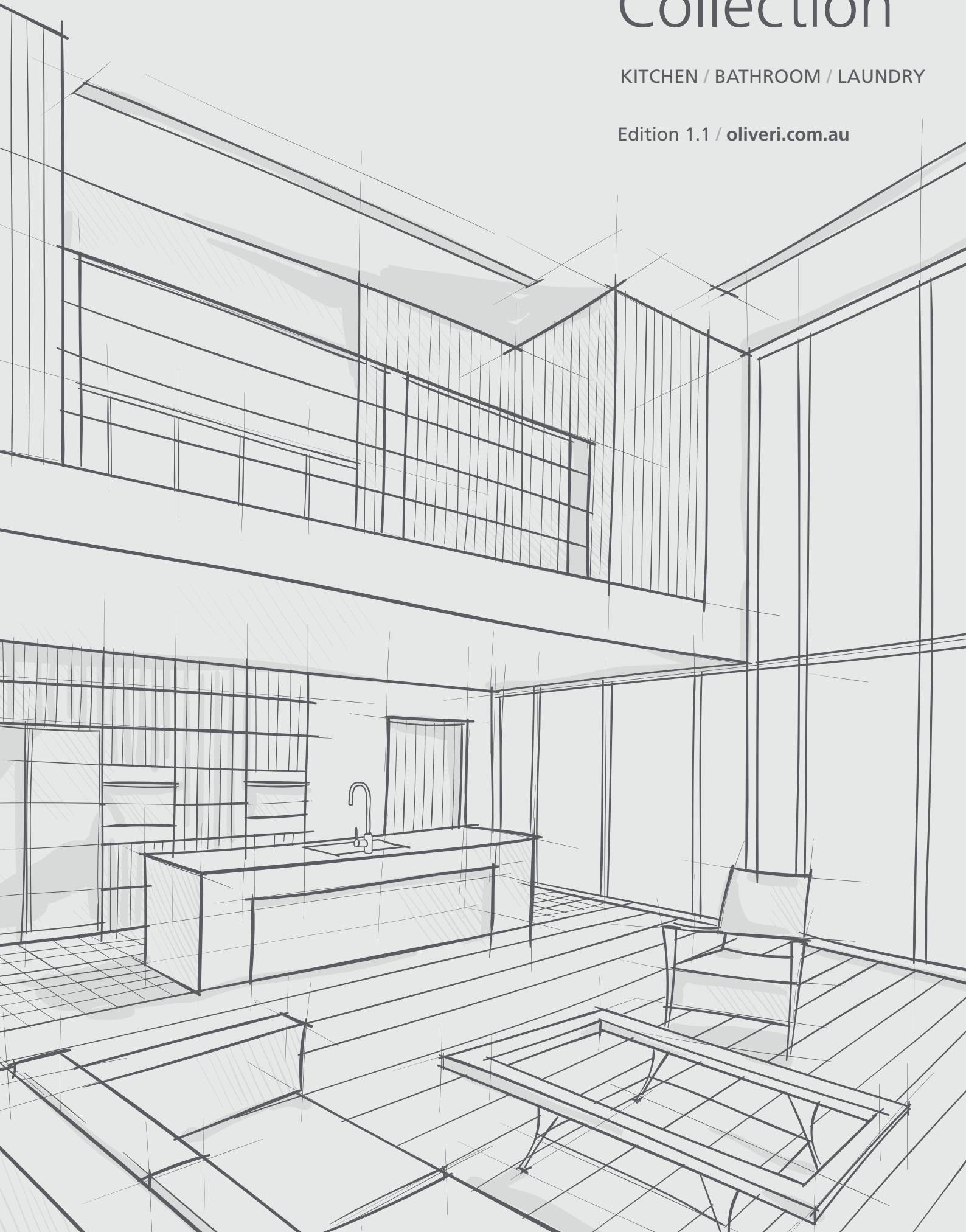

The Oliveri Story

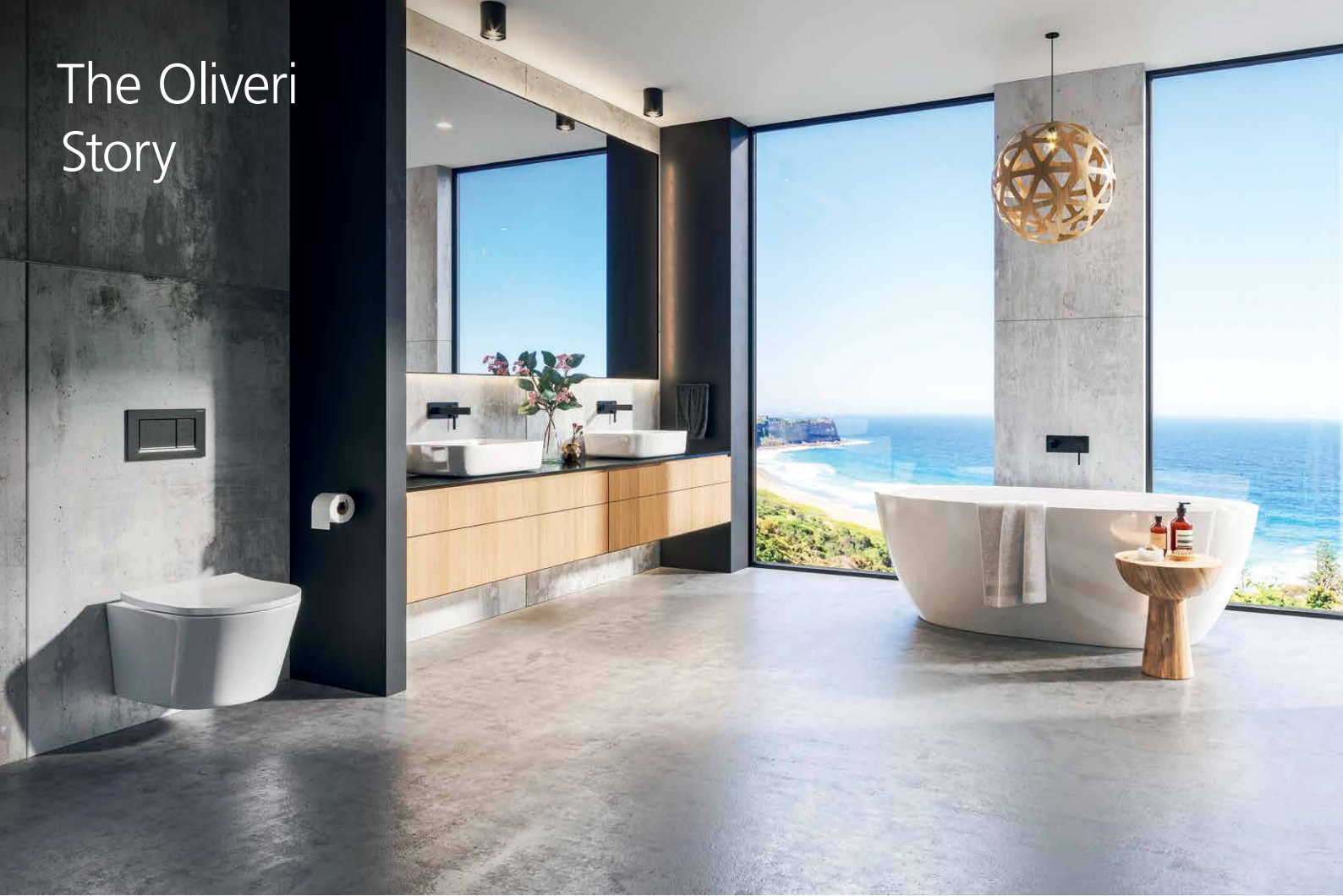

Beginning in an unassuming factory way back in 1947, Watkins & Starr (now Oliveri Solutions) started out as a local steel fabricator in Adelaide, South Australia, where a highly skilled and dedicated team pioneered the deep drawing manufacturing process in Australia.

It was the beginning of something extraordinary. 75 years later, Oliveri is Australia's only pressed bowl sink manufacturer and one of the country's true home grown success stories.

Australian made. Global success.

Our design focus and commitment to quality continues, with a complete range beautifully designed tapware, showers, sanitaryware, sinks and water filter systems that help Australian families bring their kitchen & bathroom dreams to life.

The Oliveri range offers beautifully designed kitchen, laundry and bathroom products, inspired by global trends while presenting a uniquely Australian touch: the Oliveri name continues to be synonymous with style, quality, and thoughtful design.



Contents

- 04 / Kitchen / Laundry Sinks
- 09 / Tapware Kitchen & Laundry
- 13 / Tapware Bathroom
- 17 / Basins
- 20 / Showers
- 24 / Toilet Suites
- 26 / Baths
- 27 / Accessories

Environmental Statement

This catalogue was printed using vegetable based inks on paper sourced from sustainable forests.



International Products

Selected Oliveri sinks, accessories and taps are sourced from international suppliers. They are designed and manufactured to Oliveri's specifications and quality standards.

Warranty

Our goods come with guarantees that cannot be excluded under the Australian Consumer Law. You are entitled to a replacement or refund for a major failure and for compensation for any other reasonably foreseeable loss or damage. You are also entitled to have the goods repaired or replaced if the goods fail to be of acceptable quality and the failure does not amount to a major failure. Refer to oliveri.com.au for warranty details.

Oliveri Solutions

© Registered trademark of Oliveri Solutions. Under its policy of ongoing product development, Oliveri Solutions may from time to time change product specification without notice. **WARNING:** Products in this brochure and all literature pertaining to, are subject to Intellectual Property Protection. All dimensions given are approximate and should be checked prior to installation. The product images shown are for illustration purposes only and may not be an exact representation of the actual product.

Working with Oliveri



Full Home Solution

Offering a **single brand solution** offers home owners a seamless style from your kitchen, bathroom and laundry needs, while simplifying access to product information, sales service and warranty management.



Heritage

Oliveri is synonymous with reliability & quality, offering class leading products to Australians for over **75 years**.



Dedicated Service

Work with a **dedicated local account manager** assigned to you and your project, ensuring everything runs smoothly.



Proudly Aussie Made

We are Australia's only commercial pressed bowl sink manufacturer, and a passionate champion of Australian manufacturing. **Our sink factory is located in Adelaide, South Australia**, producing world class products with sustainability and quality at the forefront.



Partnership Support

Oliveri partners with the industry's leading **builder's and plumbing merchants**, with outstanding service offered in conjunction with Oliveri's industry leading sales & service teams



National Distribution

Oliveri operates high volume distribution centres in every major capital city in Australia & New Zealand. Holding commercial quantities of all products in every location, **we will deliver on time and in full, every day**. Even better, with locally manufactured product at the core of our business, we can produce product fast for those urgent jobs.



Special Orders

Need something unique? Our in-house design capabilities mean we can develop **bespoke and exclusive designs**.



Designed To Stand The Test Of Time

Offering industry leading warranties across our ranges, our kitchen sinks offer a **lifetime manufacturer's warranty**, and our bathroom products offer warranties of up to 20 years*.



Local Support

Oliveri's **customer service and warranty teams** are located right here in Australia - you can be sure you'll receive fast, reliable service from those who understand your needs.



Sustainability

We are committed to reducing our impact on the environment.

Our manufacturing facility operates zero-waste-to-landfill, and we are committed to carbon footprint reduction through solar power generation. Stainless steel, the core of our business is a long lasting material that can be repeatedly recycled, and a large majority of Oliveri product packaging is also recyclable.

Oliveri

Oliveri Solutions Pty Ltd ABN 12 007 551 886
A member of the Fletcher Building Group.

PO Box 2141 Regency Park, SA 5942 Australia
P 61 8 8348 6444 E sales@oliveri.com.au

*Visit oliveri.com.au for full warranty details.

Kitchen / Laundry Sinks

Double Bowl Topmount Sink

Brushed Stainless Steel / PS64

Min Cabinet Size: 800mm

Capacity: $\frac{3}{4}$ Bowl / 30 litres x 2

Material:
304 grade, 18/10 brushed
stainless steel (1.2 mm thick)

Fixings:
Installation clips supplied

Tap Holes: 1

Included Waste Fittings:
2 x 90mm basket wastes

Warranty*: Lifetime

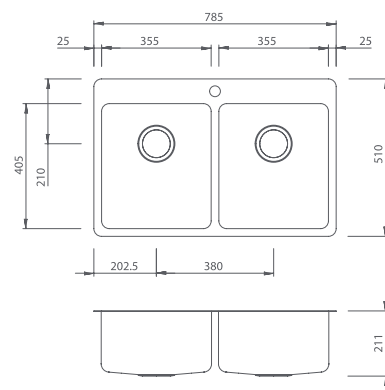

Double Bowl Universal Sink

Brushed Stainless Steel / PS63TU

Min Cabinet Size: 900mm

Capacity:
 $\frac{3}{4}$ Bowl / 30 litres x 2

Material:
304 grade, 18/10 brushed
stainless steel (1.2 mm thick)

Fixings:
Installation clips supplied

Tap Holes: N/A

Included Waste Fittings:
2 x 90mm basket wastes

Warranty*: Lifetime

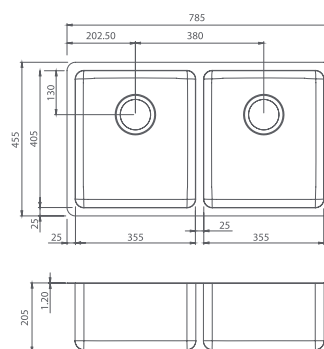

3/4 & 1/2 Bowl Universal Sink

Brushed Stainless Steel / PS83TU

Min Cabinet Size: 900mm

Capacity:
 $\frac{3}{4}$ Bowl / 30 litres
 $\frac{1}{2}$ Bowl / 16 litres

Material:
304 grade, 18/10 brushed
stainless steel (1.2 mm thick)

Fixings: Installation clips supplied

Tap Holes: N/A

Included Waste Fittings:
2 x 90mm basket wastes

Warranty*: Lifetime

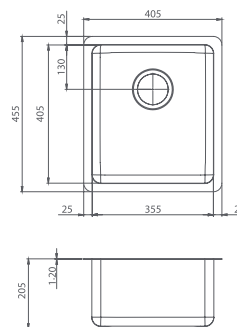

Mega Bowl Universal Sink

Polished Stainless Sink / PS90TU

Min Cabinet Size: 900mm

Capacity: Mega Bowl / 62 litres

Material:
304 grade, 18/10 brushed
stainless steel (1.2 mm thick)

Fixings:
Installation clips supplied

Tap Holes: N/A

Included Waste Fittings:
1 x 90mm basket waste

Warranty*: Lifetime

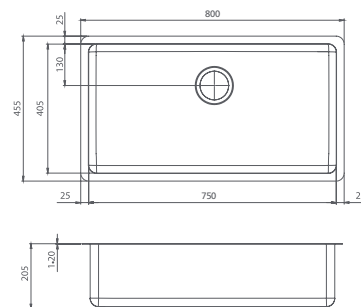

Available in more options, see the full collection at oliveri.com.au

Kitchen / Laundry Sinks

Single Large Bowl Universal Sink

Polished Stainless Steel / PS50TU

Min Cabinet Size: 600mm

Capacity: Large Bowl / 39 litres

Material:

304 grade, 18/10 brushed stainless steel (1.2 mm thick)

Fixings:

Installation clips supplied

Tap Holes: N/A

Included Waste Fittings:

1 x 90mm basket waste

Warranty*: Lifetime

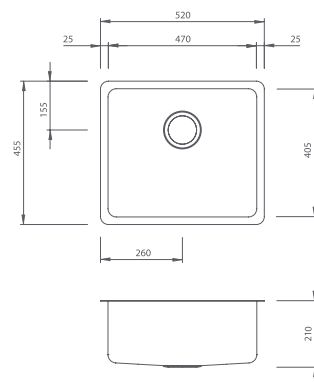

Single Bowl Universal Sink

Brushed Stainless Steel / PS30TU

Min Cabinet Size: 500mm

Capacity:

¾ Bowl / 30 litres

Material:

304 grade, 18/10 brushed stainless steel (1.2 mm thick)

Fixings: Installation clips supplied

Tap Holes: N/A

Included Waste Fittings:

1 x 90mm basket waste

Warranty*: Lifetime

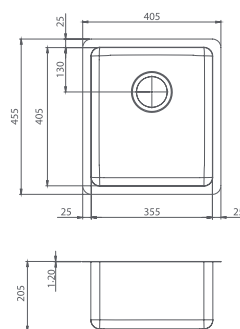

Double Bowl Sink With Drainer

Polished Stainless Steel / PS206 left hand bowl / PS207 right hand bowl

Min Cabinet Size: 800mm

Capacity: Main Bowl / 21 litres x 2

Material:

304 grade, 18/10 brushed stainless steel (0.8 mm thick)

Fixings:

Adjustable clips supplied and sealing gasket fitted

Tap Holes: 0-1 tap holes*

Included Waste Fittings:

2 x 90mm basket wastes

Warranty*: Lifetime

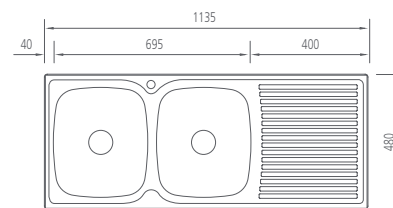

1 & ¾ Bowl Sink With Drainer

Polished Stainless Sink / PS176 left hand bowl / PS177 right hand bowl

Min Cabinet Size: 700mm

Capacity: Main Bowl / 21 litres and ¾ Bowl / 12 litres

Material:

304 grade, 18/10 brushed stainless steel (0.8 mm thick)

Fixings:

Adjustable clips supplied and sealing gasket fitted

Tap Holes: 0-1 tap holes*

Included Waste Fittings:

2 x 90mm basket wastes

Warranty*: Lifetime

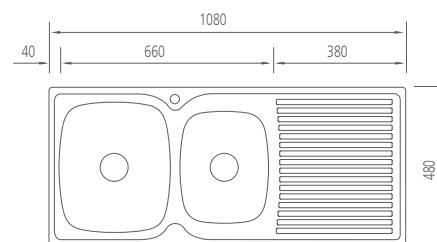

Available in more options, see the full collection at oliveri.com.au

*Visit oliveri.com.au for full warranty details. *Specify when ordering.

Kitchen / Laundry Sinks

Double Bowl Topmount Sink With Drainer

Polished Stainless Steel / PS171 left hand bowl / PS172 right hand bowl

Min Cabinet Size:
800mm

Capacity:
Main Bowl / 21 litres x 2

Material:
304 grade, 18/10
brushed stainless steel
(0.8 mm thick)

Fixings:
Adjustable clips and
sealing foam supplied

Tap Holes: 0-1 tap holes*

Included Waste Fittings:
2 x 90mm basket wastes

Warranty*: Lifetime

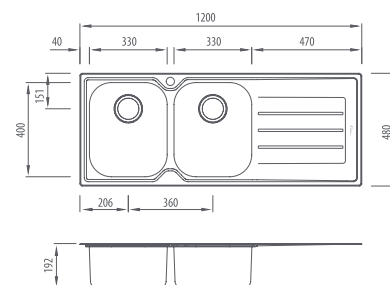

1 & ¾ Bowl Topmount Sink With Drainer

Polished Stainless Steel / PS111 left hand bowl / PS112 right hand bowl

Min Cabinet Size:
700mm

Capacity:
Main Bowl / 21 litres x 2
¾ Bowl / 11 litres

Material:
304 grade, 18/10
brushed stainless steel
(0.8 mm thick)

Fixings:
Adjustable clips and
sealing foam supplied

Tap Holes: 0-3 tap holes*

Included Waste Fittings:
2 x 90mm basket wastes

Warranty*: Lifetime

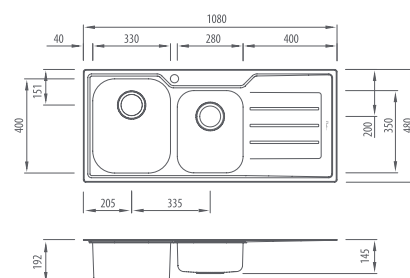

Single Bowl Topmount Sink With Drainer

Polished Stainless Steel / PS121 left hand bowl / PS122 right hand bowl

Min Cabinet Size:
500mm

Capacity:
Main Bowl / 21 litres

Material:
304 grade, 18/10
brushed stainless steel
(0.8 mm thick)

Fixings:
Adjustable clips and
sealing foam supplied

Tap Holes: 0-1 tap holes*

Included Waste Fittings:
1 x 90mm basket waste

Warranty*: Lifetime

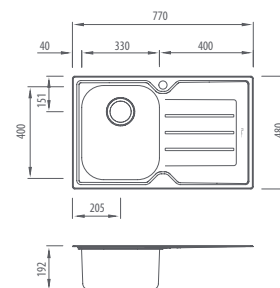

Available in more options, see the full collection at oliveri.com.au

Kitchen / Laundry Sinks

Double Bowl Sink With Drainer

Polished Stainless Steel / PS71 left hand bowl / PS72 right hand bowl

Min Cabinet Size: 800mm

Capacity: Main Bowl / 21 litres x 2

Material:
304 grade, 18/10 brushed stainless steel (0.8 mm thick)

Fixings:
Adjustable clips supplied and sealing gasket fitted

Tap Holes: 0-1 tap holes[^]

Included Waste Fittings:
2 x 90mm basket wastes

Warranty*: Lifetime

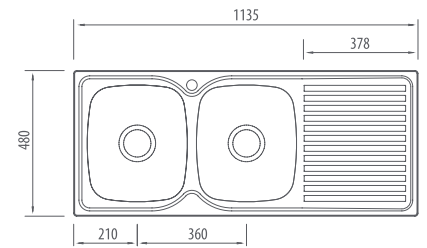

1 & ¾ Bowl Sink With Drainer

Polished Stainless Steel / PS11 left hand bowl / PS12 right hand bowl

Min Cabinet Size: 700mm

Capacity: Main Bowl / 21 litres and ¾ Bowl / 12 litres

Material:
304 grade, 18/10 brushed stainless steel (0.8 mm thick)

Fixings:
Adjustable clips supplied and sealing gasket fitted

Tap Holes: 0-1 tap holes[^]

Included Waste Fittings:
2 x 90mm basket wastes

Warranty*: Lifetime

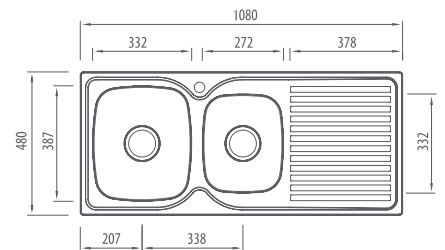

Single Bowl Sink With Drainer

Polished Stainless Steel / PS21 left hand bowl / PS22 right hand bowl

Min Cabinet Size: 500mm

Capacity: Main Bowl / 21 litres

Material:
304 grade, 18/10 brushed stainless steel (0.8 mm thick)

Fixings:
Adjustable clips supplied and sealing gasket fitted

Tap Holes: 0-1 tap holes[^]

Included Waste Fittings:
1 x 90mm basket waste

Warranty*: Lifetime

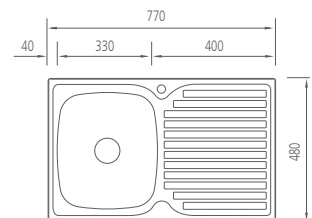

Double Bowl Universal Sink

Polished Stainless Sink / PS23TU

Min Cabinet Size: 800mm

Capacity: Main Bowl / 21 litres x 2

Material:
304 grade, 18/10 brushed stainless steel (0.8 mm thick)

Fixings: Available on request

Tap Holes: 0-1 tap holes[^]

Included Waste Fittings:
2 x 90mm basket wastes

Warranty*: Lifetime

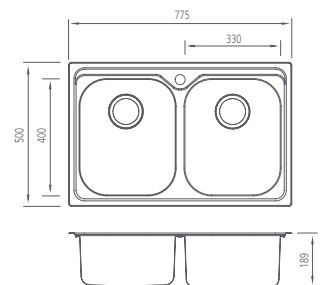

Available in more options, see the full collection at oliveri.com.au

*Visit oliveri.com.au for full warranty details. [^]Specify when ordering.

Kitchen / Laundry Sinks

Round Bowl Topmount Sink With Tap Landing

Polished Stainless Sink / LR515

Min Cabinet Size: 500mm

Capacity: Round Bowl / 24 litres

Material: 304 grade, 18/10 brushed stainless steel (0.8 mm thick)

Fixings: Adjustable clips and sealing foam supplied

Tap Holes: 1

Included Waste Fittings: 1 x 90mm basket waste

Warranty*: Lifetime

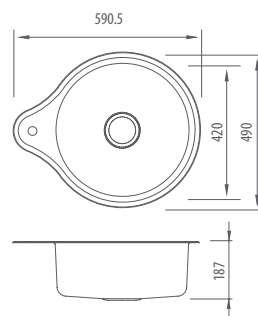

Round Bowl Universal Sink

Polished Stainless Sink / LR510

Min Cabinet Size: 500mm

Capacity: Round Bowl / 24 litres

Material: 304 grade, 18/10 brushed stainless steel (0.8 mm thick)

Fixings: Adjustable clips and sealing foam supplied

Tap Holes: N/A

Included Waste Fittings: 1 x 90mm basket waste

Warranty*: Lifetime

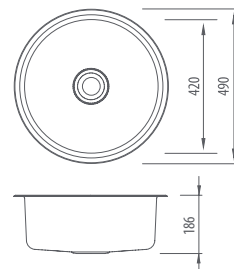

45L Laundry Tub

Polished Stainless Sink / TI45

Min Cabinet Size: 600mm

Capacity: Laundry Tub / 45 litres

Material: 304 grade, 18/10 brushed stainless steel (0.8 mm thick)

Fixings: Adjustable clips and sealing foam supplied

Tap Holes: 0-2 tap holes*

Included Waste Fittings: 1 x 90mm basket waste

Warranty*: Lifetime

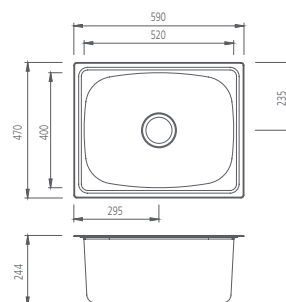

70L Laundry Tub

Polished Stainless Sink / TI70

Min Cabinet Size: 700mm

Capacity: Tub Bowl / 70 litres

Material: 304 grade, 18/10 brushed stainless steel (0.8 mm thick)

Fixings: Adjustable clips and sealing foam supplied

Tap Holes: 0-2 tap holes*

Included Waste Fittings: 1 x 90mm basket waste

Warranty*: Lifetime

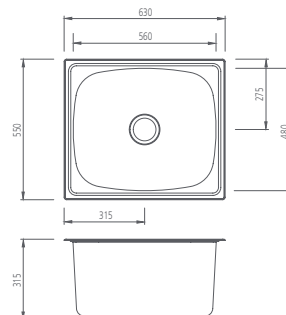

Rinse Bypass Kit

AC12



Available in more options, see the full collection at oliveri.com.au

Tapware / Kitchen & Laundry

Goose Neck Pull Out Mixer

Chrome
VE520CR-P

WELS:
5 Star / 5.0 Litres per minute

Operating pressure:
150 kPa - 500 kPa

Materials:
Brass body (DZR low lead)

Cartridge type:
Ceramic disc cartridge



Also available in:

- Matte black
- Brushed Nickel

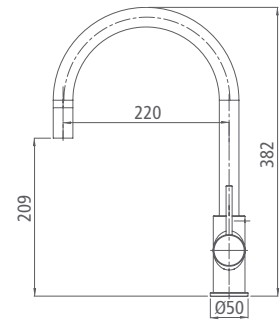

Goose Neck Mixer

Chrome
VE520CR

WELS:
5 Star / 5.5 Litres per minute

Operating pressure:
150 kPa - 500 kPa

Materials:
Brass body (DZR low lead)

Cartridge type:
Ceramic disc cartridge



Also available in:

- Matte black
- Brushed Nickel

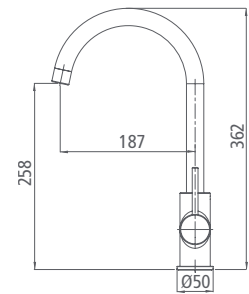

Pull Out Spray Mixer

Chrome
LON580CR-P

WELS: 5 Star / 5.0 Litres per minute

Operating pressure: 150 kPa - 500 kPa

Materials: Brass body (DZR low lead)

Cartridge type: Ceramic disc cartridge



Also available in:

- Matte black
- Brushed Nickel

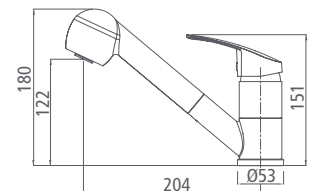

Single Lever Mixer

Chrome
LON580CR

WELS: 5 Star / 5.5 Litres per minute

Operating pressure: 150 kPa - 500 kPa

Materials: Brass body (DZR low lead)

Cartridge type: Ceramic disc cartridge



Also available in:

- Matte black
- Brushed Nickel

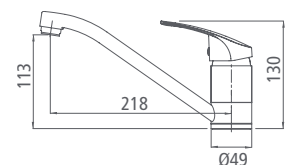

Available in more options, see the full collection at oliveri.com.au

*Visit oliveri.com.au for full warranty details.

Tapware / Kitchen & Laundry

Pull Out Right Angle Mixer

Chrome
VE570CR-P

WELS:
5 Star / 5.0 Litres per minute

Operating pressure:
150 kPa - 500 kPa

Materials:
Brass body (DZR low lead)
Cartridge type:
Ceramic disc cartridge



Also available in:

- Matte black
- Brushed Nickel

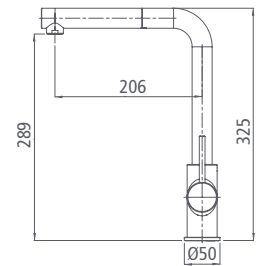

Right Angle Mixer

Chrome
VE570CR

WELS:
5 Star / 5.5 Litres per minute

Operating pressure:
150 kPa - 500 kPa

Materials:
Brass body (DZR low lead)
Cartridge type:
Ceramic disc cartridge



Also available in:

- Matte black
- Brushed Nickel

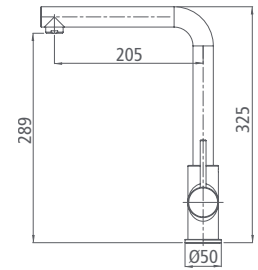

Pull Out Swivel Mixer

Chrome
VE590CR-P

WELS:
5 Star / 5.0 Litres per minute

Operating pressure:
150 kPa - 500 kPa

Materials:
Brass body (DZR low lead)
Cartridge type:
Ceramic disc cartridge



Also available in:

- Matte black
- Brushed Nickel

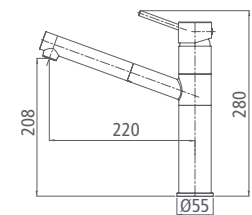

Swivel Mixer

Chrome
VE590CR

WELS:
5 Star / 5.5 Litres per minute

Operating pressure:
150 kPa - 500 kPa

Materials:
Brass body (DZR low lead)
Cartridge type:
Ceramic disc cartridge



Also available in:

- Matte black
- Brushed Nickel

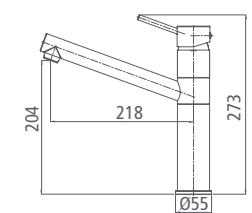

Available in more options, see the full collection at oliveri.com.au

*Visit oliveri.com.au for full warranty details.

Tapware / Kitchen & Laundry

Goose Neck Pull Out Mixer

Natural Stainless Steel
SS2525

WELS:
4 Star / 7.5 Litres per minute

Operating pressure:
150 kPa - 500 kPa

Materials:
304 Grade stainless steel body

Cartridge type:
Ceramic disc cartridge

Warranty*:
10 years



Also available in:

- Black
- Gunmetal
- Brushed Gold

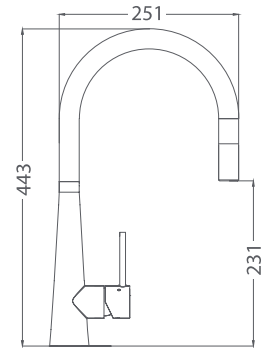

Goose Neck Mixer

Natural Stainless Steel
SS2520

WELS:
4 Star / 7.5 Litres per minute

Operating pressure:
150 kPa - 500 kPa

Materials:
304 Grade stainless steel body

Cartridge type:
Ceramic disc cartridge

Warranty*:
10 years

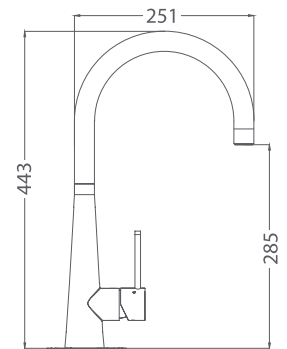

Right Angle Mixer

Natural Stainless Steel
SS2540

WELS:
4 Star / 7.5 Litres per minute

Operating pressure:
150 kPa - 500 kPa

Materials:
304 Grade stainless steel body

Cartridge type:
Ceramic disc cartridge

Warranty*:
10 years

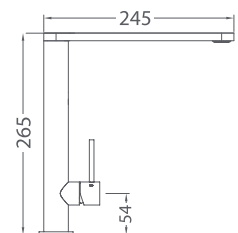

Available in more options, see the full collection at oliveri.com.au

*Visit oliveri.com.au for full warranty details.

Tapware / Kitchen & Laundry

Square Goose Neck Pull Out Mixer

Natural Stainless Steel
SS2575

WELS:
4 Star / 7.5 Litres per minute

Operating pressure:
150 kPa - 500 kPa

Materials:
304 Grade stainless steel body

Cartridge type:
Ceramic disc cartridge

Warranty*:
10 years



Also available in:

- Black
- Gunmetal
- Brushed Gold

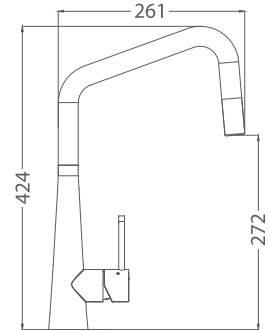

Square Goose Neck Mixer

Natural Stainless Steel
SS2570

WELS:
4 Star / 7.5 Litres per minute

Operating pressure:
150 kPa - 500 kPa

Materials:
304 Grade stainless steel body

Cartridge type:
Ceramic disc cartridge

Warranty*:
10 years

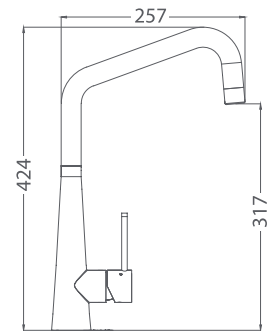

Swivel Pull Out Mixer

Natural Stainless Steel
SS2515

WELS: 4 Star / 7.5 Litres per minute

Operating pressure: 150 kPa - 500 kPa

Materials: 304 Grade stainless steel body

Cartridge type: Ceramic disc cartridge

Warranty*: 10 years

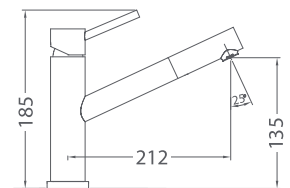

Swivel Mixer

Natural Stainless Steel
SS2510

WELS: 4 Star / 7.5 Litres per minute

Operating pressure: 150 kPa - 500 kPa

Materials: 304 Grade stainless steel body

Cartridge type: Ceramic disc cartridge

Warranty*: 10 years

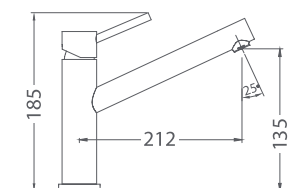

Available in more options, see the full collection at oliveri.com.au

*Visit oliveri.com.au for full warranty details.

Tapware / Bathroom

Curved Tower Basin Mixer

Chrome / VE104500CR

WELS:

5 Star / 6 Litres per minute

Temperature rating (min / max):
1°C - 65°C

Pressure rating (min / max):
150 kPa - 500 kPa

Materials:

Brass body and zinc handle with SUS handle lever

Cartridge type:

Ceramic disc cartridge

Warranty*:

15 years cartridge, body and finish;
5 years seals, tails, fittings, aerators;
1 year labour

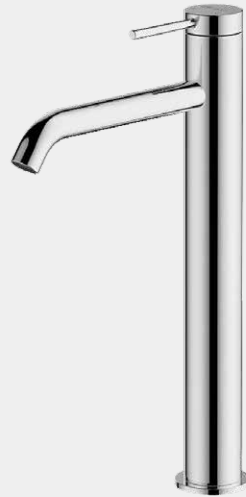

Also available in:

- Matte black
- Gunmetal
- Brushed Nickel
- Classic Gold

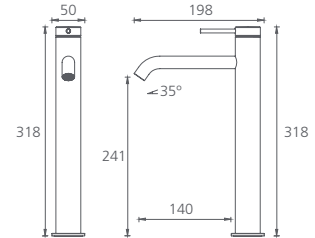

Curved Basin Mixer

Chrome / VE103500CR

WELS: 5 Star / 6 Litres per minute

Temperature rating (min / max):
1°C - 65°C

Pressure rating (min / max): 150 kPa - 500 kPa

Materials: Brass body and zinc handle with SUS handle lever

Cartridge type: Ceramic disc cartridge

Warranty*: 15 years cartridge, body and finish;
5 years seals, tails, fittings, aerators; 1 year labour



Also available in:

- Matte black
- Gunmetal
- Brushed Nickel
- Classic Gold

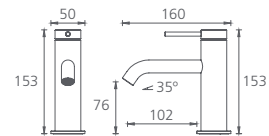

Uplift Tower Basin Mixer

Chrome / VE110500CR

WELS:

5 Star / 6 Litres per minute

Temperature rating (min / max):
1°C - 65°C

Pressure rating (min / max):
150 kPa - 500 kPa

Materials:

Brass body and zinc handle with SUS handle lever

Cartridge type:

Ceramic disc cartridge

Warranty*:

15 years cartridge, body and finish;
5 years seals, tails, fittings, aerators;
1 year labour

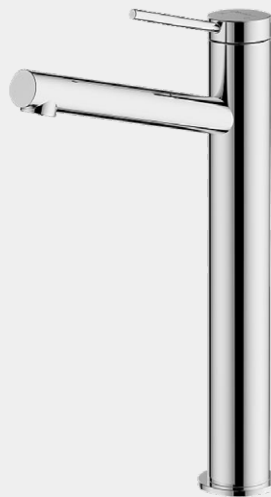

Also available in:

- Matte black
- Gunmetal
- Brushed Nickel
- Classic Gold

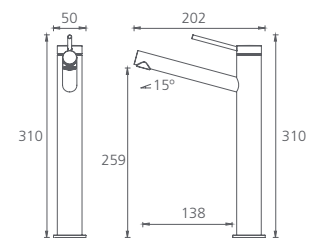

Uplift Basin Mixer

Chrome / VE109500CR

WELS: 5 Star / 6 Litres per minute

Temperature rating (min / max):
1°C - 65°C

Pressure rating (min / max): 150 kPa - 500 kPa

Materials: Brass body and zinc handle with SUS handle lever

Cartridge type: Ceramic disc cartridge

Warranty*: 15 years cartridge, body and finish;
5 years seals, tails, fittings, aerators; 1 year labour



Also available in:

- Matte black
- Gunmetal
- Brushed Nickel
- Classic Gold

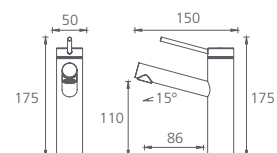

Available in more options, see the full collection at oliveri.com.au

*Visit oliveri.com.au for full warranty details.

Tapware / Bathroom

Straight Tower Basin Mixer

Chrome / VE107500CR

WELS:

5 Star / 6 Litres per minute

Temperature rating (min / max):

1°C - 65°C

Pressure rating (min / max):

150 kPa - 500 kPa

Materials:

Brass body and zinc handle with SUS handle lever

Cartridge type:

Ceramic disc cartridge

Warranty*:

15 years cartridge, body and finish;
5 years seals, tails, fittings, aerators;
1 year labour

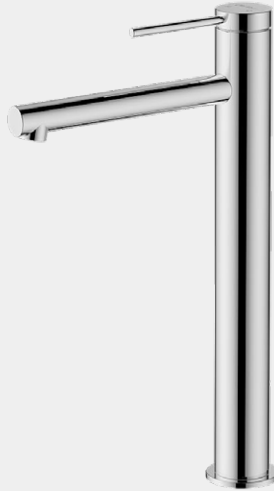

Also available in:

- Matte black
- Gunmetal
- Brushed Nickel
- Classic Gold

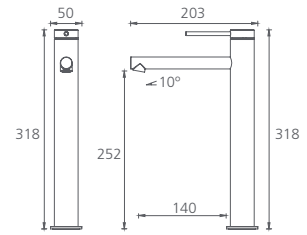

Straight Basin Mixer

Chrome / VE106500CR

WELS: 5 Star / 6 Litres per minute

Temperature rating (min / max):

1°C - 65°C

Pressure rating (min / max): 150 kPa - 500 kPa

Materials: Brass body and zinc handle with SUS handle lever

Cartridge type: Ceramic disc cartridge

Warranty*: 15 years cartridge, body and finish;
5 years seals, tails, fittings, aerators; 1 year labour



Also available in:

- Matte black
- Gunmetal
- Brushed Nickel
- Classic Gold

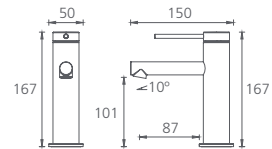

Tower Basin Mixer

Chrome / PA070520CR

WELS:

5 Star / 6 Litres per minute

Temperature rating (min / max):

1°C - 65°C

Pressure rating (min / max):

150 kPa - 500 kPa

Materials:

Brass body and zinc handle

Cartridge type:

Ceramic disc cartridge

Warranty*:

15 years cartridge, body and finish;
5 years seals, tails, fittings, aerators;
1 year labour



Also available in:

- Matte black
- Gunmetal
- Brushed Nickel
- Classic Gold

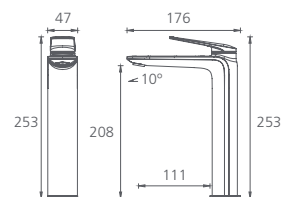

Basin Mixer

Chrome / PA069520CR

WELS: 5 Star / 6 Litres per minute

Temperature rating (min / max):

1°C - 65°C

Pressure rating (min / max): 150 kPa - 500 kPa

Materials: Brass body and zinc handle

Cartridge type: Ceramic disc cartridge

Warranty*: 15 years cartridge, body and finish;
5 years seals, tails, fittings, aerators; 1 year labour



Also available in:

- Matte black
- Gunmetal
- Brushed Nickel
- Classic Gold

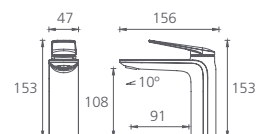

Available in more options, see the full collection at oliveri.com.au

*Visit oliveri.com.au for full warranty details.

Tapware / Bathroom

Curved Wall Mixer Set

Chrome / VE105500CR

WELS: 5 Star / 6 Litres per minute

Temperature rating (min / max): 1°C - 65°C

Pressure rating (min / max): 150 kPa - 500 kPa

Materials: Brass body and zinc handle with SUS handle lever

Cartridge type: Ceramic disc cartridge

Warranty*: 15 years cartridge, body and finish; 5 years seals, tails, fittings, aerators; 1 year labour

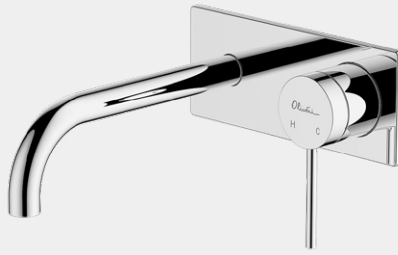

Also available in:

- Matte black ● Gunmetal
- Brushed Nickel ● Classic Gold

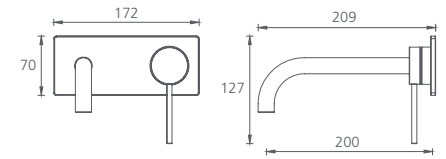

Straight Wall Mixer Set

Chrome / VE108500CR

WELS: 5 Star / 6 Litres per minute

Temperature rating (min / max): 1°C - 65°C

Pressure rating (min / max): 150 kPa - 500 kPa

Materials: Brass body and zinc handle with SUS handle lever

Cartridge type: Ceramic disc cartridge

Warranty*: 15 years cartridge, body and finish; 5 years seals, tails, fittings, aerators; 1 year labour

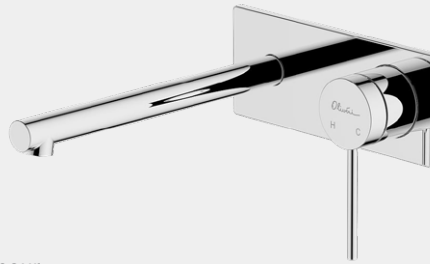

Also available in:

- Matte black ● Gunmetal
- Brushed Nickel ● Classic Gold

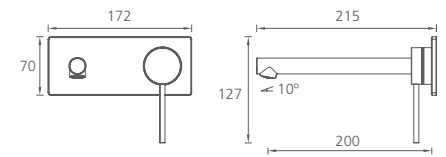

Wall Mixer Set

Chrome / PA102500CR

WELS: 5 Star / 6 Litres per minute

Temperature rating (min / max): 1°C - 65°C

Pressure rating (min / max): 150 kPa - 500 kPa

Materials: Brass body and zinc handle

Cartridge type: Ceramic disc cartridge

Warranty*: 15 years cartridge, body and finish; 5 years seals, tails, fittings, aerators; 1 year labour



Also available in:

- Matte black ● Gunmetal
- Brushed Nickel ● Classic Gold

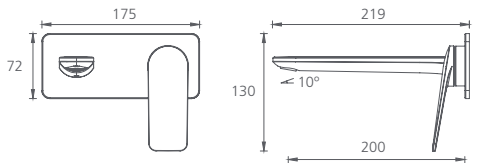

Curved Wall Spout

Chrome / VE105200CR

WELS: 5 Star / 6 Litres per minute

Temperature rating (min / max): 1°C - 65°C

Pressure rating (min / max): 150 kPa - 500 kPa

Materials: Brass spout

Warranty*: 15 years cartridge, body and finish; 5 years seals, tails, fittings, aerators; 1 year labour



Also available in:

- Matte black ● Gunmetal
- Brushed Nickel ● Classic Gold

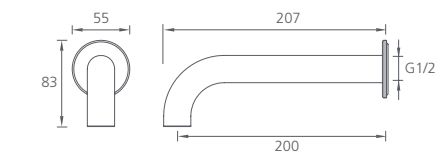

Straight Wall Spout

Chrome / VE108200CR

WELS: 5 Star / 6 Litres per minute

Temperature rating (min / max): 1°C - 65°C

Pressure rating (min / max): 150 kPa - 500 kPa

Materials: Brass spout

Warranty*: 15 years cartridge, body and finish; 5 years seals, tails, fittings, aerators; 1 year labour

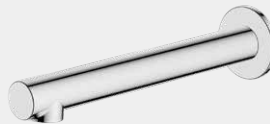

Also available in:

- Matte black ● Gunmetal
- Brushed Nickel ● Classic Gold

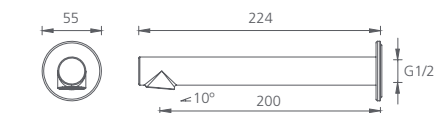

Wall Spout

Chrome / PA102200CR

WELS: 5 Star / 6 Litres per minute

Temperature rating (min / max): 1°C - 65°C

Pressure rating (min / max): 150 kPa - 500 kPa

Materials: Brass spout

Warranty*: 15 years cartridge, body and finish; 5 years seals, tails, fittings, aerators; 1 year labour



Also available in:

- Matte black ● Gunmetal
- Brushed Nickel ● Classic Gold

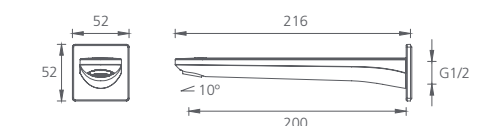

Available in more options, see the full collection at oliveri.com.au

*Visit oliveri.com.au for full warranty details.

Tapware / Bathroom

Wall Mixer With Diverter

Chrome / PA101500CR

Temperature rating (min / max): 1°C - 65°C

Pressure rating (min / max): 150 kPa - 500 kPa

Materials: Brass body and zinc handle

Cartridge type: Ceramic disc cartridge

Warranty*:

15 years cartridge and body;

10 years finish;

5 years seals, fittings;

1 year labour

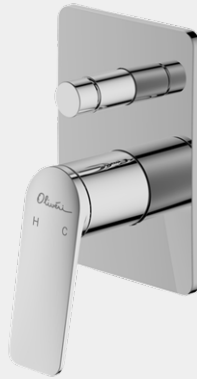

Also available in:

- Matte black
- Gunmetal
- Brushed Nickel
- Classic Gold

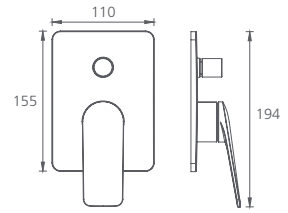

Wall Mixer With Diverter

Chrome / VE112500CR

Temperature rating (min / max): 1°C - 65°C

Pressure rating (min / max): 150 kPa - 500 kPa

Materials:

Brass body and zinc handle with SUS handle lever

Cartridge type: Ceramic disc cartridge

Warranty*:

15 years cartridge and body;

10 years finish;

5 years seals, fittings;

1 year labour

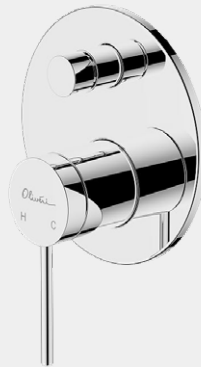

Also available in:

- Matte black
- Gunmetal
- Brushed Nickel
- Classic Gold

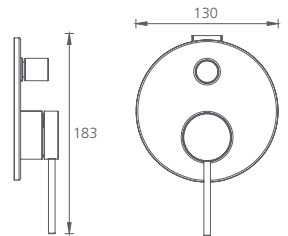

Wall Mixer

Chrome / PA100500CR

Temperature rating (min / max): 1°C - 65°C

Pressure rating (min / max): 150 kPa - 500 kPa

Materials: Brass body and zinc handle

Cartridge type: Ceramic disc cartridge

Warranty*:

15 years cartridge, body and finish;

5 years seals, tails, fittings, aerators;

1 year labour



Also available in:

- Matte black
- Gunmetal
- Brushed Nickel
- Classic Gold

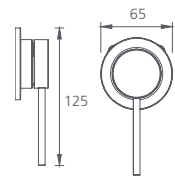

Wall Mixer

Chrome / VE111500CR

Temperature rating (min / max): 1°C - 65°C

Pressure rating (min / max): 150 kPa - 500 kPa

Materials: Brass body and zinc handle with SUS handle lever

Cartridge type: Ceramic disc cartridge

Warranty*:

15 years cartridge, body and finish;

5 years seals, tails, fittings, aerators;

1 year labour



Also available in:

- Matte black
- Gunmetal
- Brushed Nickel
- Classic Gold

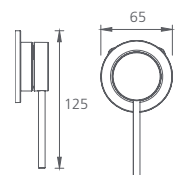

Available in more options, see the full collection at oliveri.com.au

*Visit oliveri.com.au for full warranty details.

Basins

Counter Top

Rectangular Basin
NA3711

Bowl Capacity: 14.9 litres

Materials: Vitreous china

Waste Fittings:

Pop up waste sold separately

Warranty*:

20 years replacement parts,
1 year labour

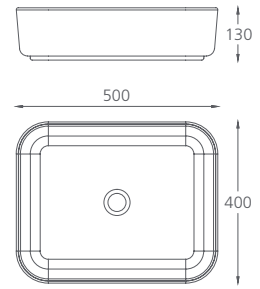

Counter Top

Square Basin
NA3721

Bowl Capacity: 12.9 litres

Materials: Vitreous china

Waste Fittings:

Pop up waste sold separately

Warranty*:

20 years replacement parts,
1 year labour

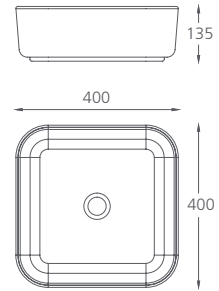

Counter Top

Rectangular Basin
DU7130C

Bowl Capacity: 4.5 litres

Materials: Vitreous china

Waste Fittings:

Pop up waste sold separately

Warranty*:

20 years replacement parts,
1 year labour

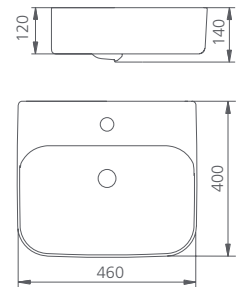

Counter Top

Square Basin
MU7063CT

Bowl Capacity: 6.8 litres

Materials: Vitreous china

Waste Fittings:

Pop up waste sold separately

Warranty*:

20 years replacement parts,
1 year labour

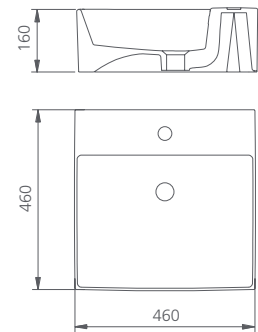

Counter Top

Round Basin
NA3771

Bowl Capacity: 9.3 litres

Materials: Vitreous china

Waste Fittings:

Pop up waste sold separately

Warranty*:

20 years replacement parts, 1 year labour

Also available in: ● Black ● Gray

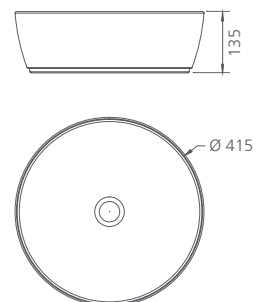

Available in more options, see the full collection at oliveri.com.au

*Visit oliveri.com.au for full warranty details.

Basins

Wall Hung

Rectangular Basin
DU7130D

Bowl Capacity: 4.5 litres

Materials: Vitreous china

Waste Fittings:

Pop up waste sold separately

Warranty*:

20 years replacement parts,
1 year labour

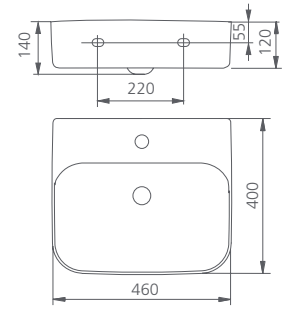

Wall Hung

Square Basin
MU7063WH

Bowl Capacity: 6.8 litres

Materials: Vitreous china

Waste Fittings:

Pop up waste sold separately

Warranty*:

20 years replacement parts,
1 year labour

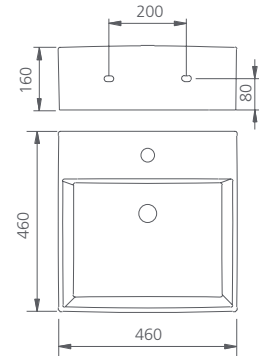

Wall Hung

Rectangular Basin
VI7131B

Bowl Capacity: 5.5 litres

Materials: Vitreous china

Waste Fittings:

Pop up waste sold separately

Warranty*:

20 years replacement parts,
1 year labour

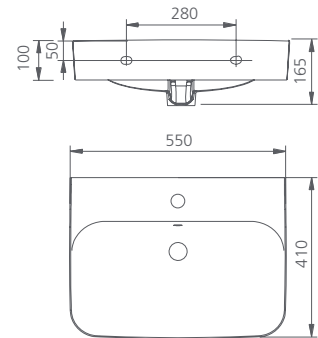

Semi-recessed

Rectangular Basin
DU7130E

Bowl Capacity: 3.5 litres

Materials: Vitreous china

Waste Fittings:

Pop up waste sold separately

Warranty*:

20 years replacement parts,
1 year labour

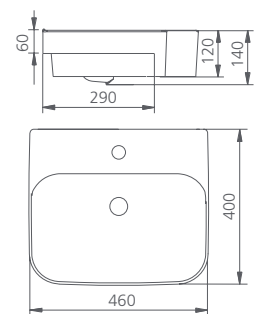

Semi-recessed

Square Basin
MU8050H

Bowl Capacity: 6.2 litres

Materials: Vitreous china

Waste Fittings:

Pop up waste sold separately

Warranty*:

20 years replacement parts,
1 year labour

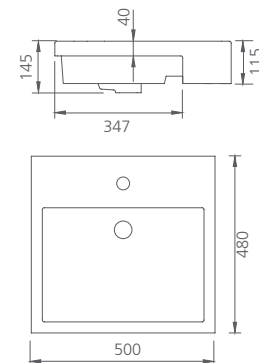

Available in more options, see the full collection at oliveri.com.au

Basins

Inset

Rectangular Basin
DU7130F

Bowl Capacity: 3.5 litres

Materials: Vitreous china

Waste Fittings:

Pop up waste sold separately

Warranty*:

20 years replacement parts,
1 year labour

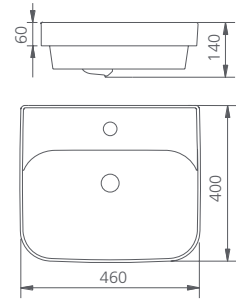

Inset

Square Basin
MU7063C

Bowl Capacity: 5.5 litres

Materials: Vitreous china

Waste Fittings:

Pop up waste sold separately

Warranty*:

20 years replacement parts,
1 year labour

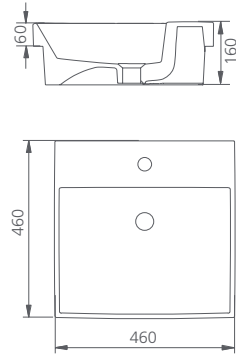

Undermount

Rectangular Basin
OS542AB

Bowl Capacity: 14.5 litres

Materials: Vitreous china

Waste Fittings:

Pop up waste sold separately

Warranty*:

20 years replacement parts,
1 year labour

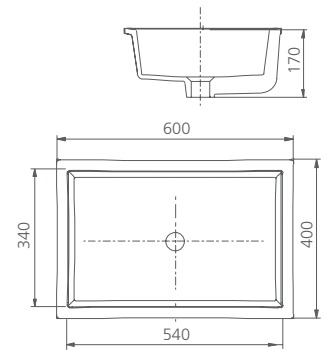

Undermount

Round Basin
OS536

Bowl Capacity: 8.5 litres

Materials: Vitreous china

Waste Fittings:

Pop up waste sold separately

Warranty*:

20 years replacement parts,
1 year labour

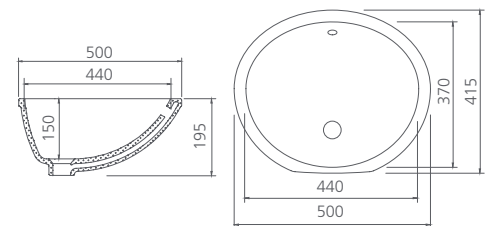

Basin Pop-up Plug And Waste

Chrome
ACC706-D-CH

Materials: Solid brass,
silicone or rubber gasket

Warranty*:

1 year parts and labour



Also available in:

- Matte black
- Gunmetal
- Brushed Nickel
- Classic Gold

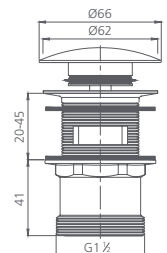

Available in more options, see the full collection at oliveri.com.au

*Visit oliveri.com.au for full warranty details.

Showers

Dual Shower Set

Chrome & white
CO10012CR

WELS:

3 Star / 9 Litres per minute

Temperature rating (min / max):
1°C - 65°C

Pressure rating (min / max):
150 kPa - 500 kPa

Materials:

Brass / ABS Plastic

Shower head functions:

Three spray functions (hand shower)

Connections:

G1/2 Female

Warranty*:

15 years main body; 7 years finish;
5 years shower head, shower arm,
plastic hand piece;
2 years hose, seals, o'rings;
1 year labour



Also available in:

● Matte black

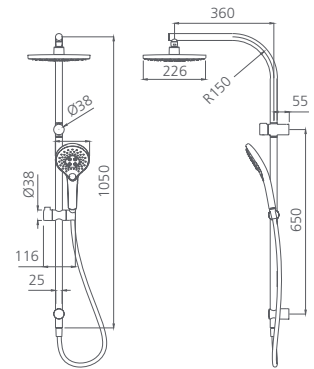

Hand Shower With Rail

Chrome & white
CO51580CR

WELS:

3 Star / 9 Litres per minute

Temperature rating (min / max):
1°C - 65°C

Pressure rating (min / max):
150 kPa - 500 kPa

Materials:

Brass / ABS Plastic

Shower head functions:

Three spray functions

Connections:

G1/2 Female

Warranty*:

15 years main body; 7 years finish;
5 years shower head, shower arm,
plastic hand piece;
2 years hose, seals, o'rings;
1 year labour



Also available in:

● Matte black

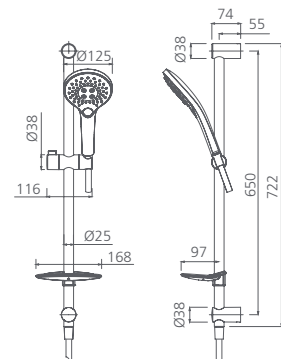

Available in more options, see the full collection at oliveri.com.au

*Visit oliveri.com.au for full warranty details.

Showers

Dual Shower Set

Chrome & white
MO36342CR

WELS:

3 Star / 9 Litres per minute

Temperature rating (min / max):
1°C - 65°C

Pressure rating (min / max):
150 kPa - 500 kPa

Materials:

Brass / ABS Plastic

Shower head functions:

Three spray functions (hand shower)

Connections:

G 1/2 BSP

Warranty*:

15 years main body;

7 years finish;

5 years shower head, shower arm,
plastic hand piece;

2 years hose, seals, o'rings;

1 year labour



Also available in:

- Matte black
- Brushed Nickel

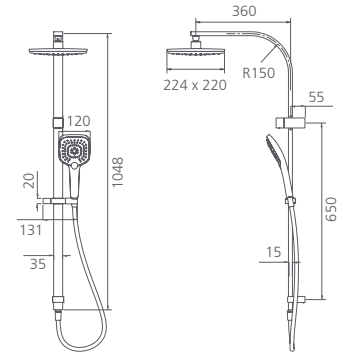

Hand Shower With Rail

Chrome & white
MO168013CR

WELS:

3 Star / 9 Litres per minute

Temperature rating (min / max):
1°C - 65°C

Pressure rating (min / max):
150 kPa - 500 kPa

Materials:

Brass / ABS Plastic

Shower head functions:

Three spray functions

Connections:

G 1/2 BSP

Warranty*:

15 years main body;

7 years finish;

5 years shower head, shower arm,
plastic hand piece;

2 years hose, seals, o'rings;

1 year labour



Also available in:

- Matte black
- Brushed Nickel

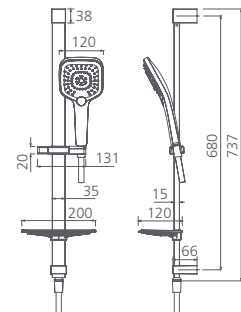

Available in more options, see the full collection at oliveri.com.au

*Visit oliveri.com.au for full warranty details.

Showers

Hand Shower With Bracket

Chrome & white / CO22230CR

WELS: 3 Star / 9 Litres per minute

Temperature rating (min / max): 1°C - 65°C

Pressure rating (min / max): 150 kPa - 500 kPa

Materials: Brass / ABS Plastic

Shower head functions: Three spray functions

Connections: G1/2 Female

Warranty*:

15 years main body;

7 years finish;

5 years shower head, shower arm, plastic hand piece;

2 years hose, seals, o'rings;

1 year labour

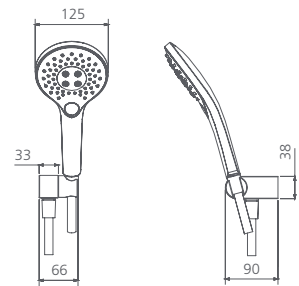

Hand Shower With Bracket

Chrome & white / MO168013BCR

WELS: 3 Star / 9 Litres per minute

Temperature rating (min / max): 1°C - 65°C

Pressure rating (min / max): 150 kPa - 500 kPa

Materials: Brass / ABS Plastic

Shower head functions: Three spray functions

Connections: G 1/2 BSP

Warranty*:

15 years main body;

7 years finish;

5 years shower head, shower arm, plastic hand piece;

2 years hose, seals, o'rings;

1 year labour

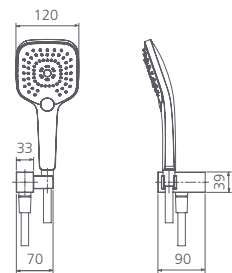

Also available in:

- Matte black
- Brushed Nickel

High Rise Shower

Chrome & white / RO140011CR

WELS: 3 Star / 9 Litres per minute

Temperature rating (min / max): 1°C - 65°C

Pressure rating (min / max): 150 kPa - 500 kPa

Materials: ABS Plastic

Connections: G 1/2 BSP

Warranty*:

5 years replacement parts and finish;

1 year labour

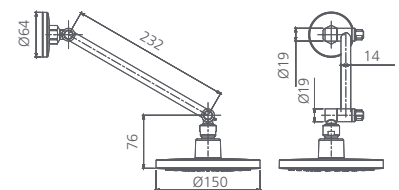

Also available in:

- Gunmetal
- Classic Gold

Available in more options, see the full collection at oliveri.com.au

*Visit oliveri.com.au for full warranty details.

Showers

Shower Rose

Chrome & white / RO26500CR

WELS: 3 Star / 9 Litres per minute

Temperature rating (min / max): 1°C - 65°C

Pressure rating (min / max): 150 kPa - 500 kPa

Materials: ABS Plastic

Connections: G1/2 Female

Warranty*: 5 years replacement parts and finish; 1 year labour



Also available in:

- Matte black
- Brushed Nickel

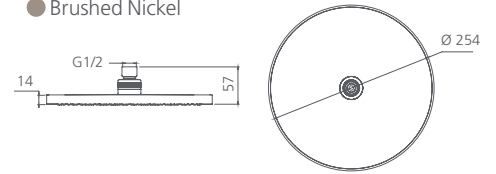

Shower Rose

Chrome & white / MO29301CR

WELS: 3 Star / 9 Litres per minute

Temperature rating (min / max): 1°C - 65°C

Pressure rating (min / max): 150 kPa - 500 kPa

Materials: ABS Plastic

Connections: G1/2 Female

Warranty*: 5 years replacement parts and finish; 1 year labour



Also available in:

- Matte black

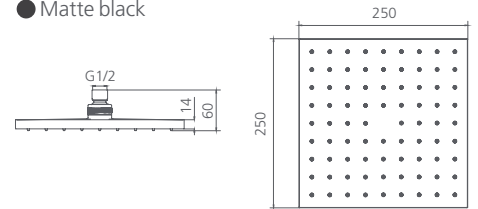

Ceiling Mounted Shower Arm

Chrome / RO15293CR

Temperature rating (min / max): 1°C - 65°C

Pressure rating (min / max): 150 kPa - 500 kPa

Materials: Brass

Connections: G 1/2 Female

Warranty*: 5 years replacement parts and finish; 1 year labour



Also available in:

- Matte black
- Brushed Nickel

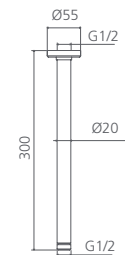

Ceiling Mounted Shower Arm

Chrome / MO0007CR

Temperature rating (min / max): 1°C - 65°C

Pressure rating (min / max): 150 kPa - 500 kPa

Materials: Brass

Connections: G 1/2 Female

Warranty*: 5 years replacement parts and finish; 1 year labour



Also available in:

- Matte black

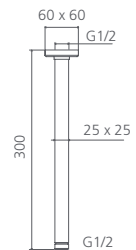

Wall Mounted Shower Arm

Chrome / RO15240CR

Temperature rating (min / max): 1°C - 65°C

Pressure rating (min / max): 150 kPa - 500 kPa

Materials: Brass Connections: G 1/2 Female

Warranty*: 5 years replacement parts and finish; 1 year labour



Also available in:

- Matte black
- Brushed Nickel

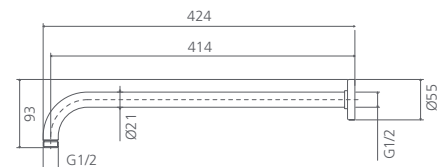

Wall Mounted Shower Arm

Chrome / MO16330CR

Temperature rating (min / max): 1°C - 65°C

Pressure rating (min / max): 150 kPa - 500 kPa

Materials: Brass Connections: G 1/2 Female

Warranty*: 5 years replacement parts and finish; 1 year labour



Also available in:

- Matte black

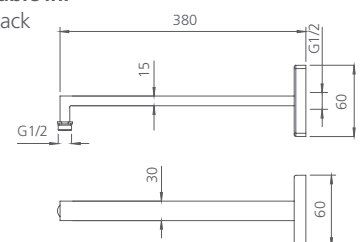

Available in more options, see the full collection at oliveri.com.au

*Visit oliveri.com.au for full warranty details.

Toilet Suites

Back To Wall Toilet Suite

VI1273

WELS: WELS 4 Star / 3.5L avg flush volume

Material: Vitreous china

Pan: Rimless / Easy-clean design

Seat: Soft close / quick release

Inlet: Bottom or back inlet

Set outs:

S-trap set out 50mm - 170mm as standard.

P-trap set out 185mm floor to centre of outlet.

Optional S-trap set out 150mm - 260mm (SPB0201)

Warranty*:

20 years vitreous china cistern and

pan replacement of product;

5 years replacement seat;

2 years valves and fittings;

1 year seals and labour



Toilet buttons available in:

- Chrome ● Matte black ● Gunmetal
- Brushed Nickel ● Classic Gold

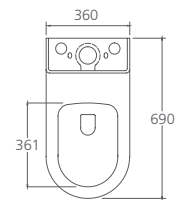
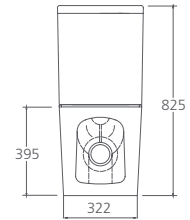

Comfort Height Back To Wall Toilet Suite

VI1273CH

WELS: WELS 4 Star / 3.5L avg flush volume

Material: Vitreous china

Pan: Rimless / Easy-clean design

Seat: Soft close / quick release

Inlet: Bottom or back inlet

Set outs:

S-trap set out 50mm - 170mm as standard.

P-trap set out 185mm floor to centre of outlet.

Optional S-trap set out 150mm - 260mm (SPB0201)

Warranty*:

20 years vitreous china cistern and

pan replacement of product;

5 years replacement seat;

2 years valves and fittings;

1 year seals and labour

Note: This toilet is Ambulant Compliant



Toilet buttons available in:

- Chrome ● Matte black ● Gunmetal
- Brushed Nickel ● Classic Gold

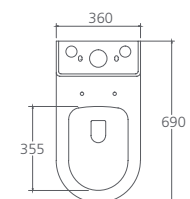
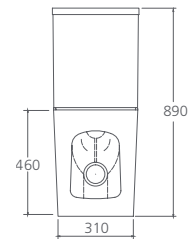

Geberit Sigma8

Flushing Systems for back to wall pans

- Suitable for S or P trap back to wall pans.
- Fits standard 90mm walls.
- WELS 4 Star 4.5L/3L.



Available in more options, see the full collection at oliveri.com.au

*Visit oliveri.com.au for full warranty details.

Toilet Suites

Wall Hung Toilet Suite

OS0513-PSC

WELS: WELS 4 Star / 3.5L avg flush volume

Material: Vitreous china

Pan: Rimless / Easy-clean design

Seat: Soft close / quick release

Set outs: P-trap

Warranty*:

20 years vitreous china cistern and pan replacement of product;

5 years replacement seat;

2 years valves and fittings;

1 year seals and labour

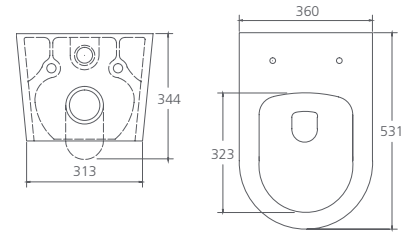

Wall Hung Toilet Suite

OS127-PSC

WELS: WELS 4 Star / 3.5L avg flush volume

Material: Vitreous china

Pan: Rimless / Easy-clean design

Seat: Soft close / quick release

Set outs: S-trap set out 50mm - 75mm as standard.

P-trap set out 185mm floor to centre of outlet.

Optional S-trap set out 150mm - 170mm (SPB0201)

Warranty*:

20 years vitreous china cistern and pan replacement of product;

5 years replacement seat;

2 years valves and fittings;

1 year seals and labour

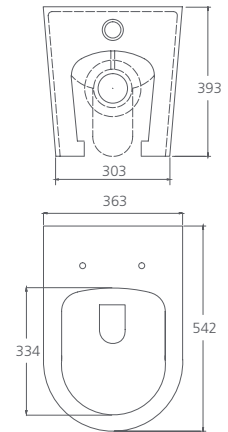

Chrome Square Flush Plate

SQRRCR

Also available in:

● Gloss black

● Matte black

● Matte white

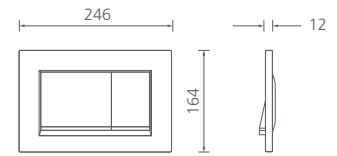

Chrome Round Flush Plate

RDPPCR

Also available in:

● Gloss black

● Matte black

● Matte white

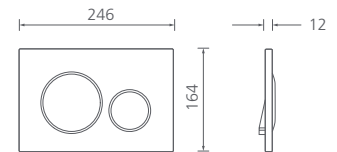
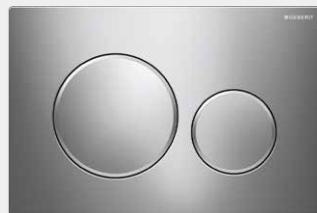

Geberit Sigma8 Duofix

for wall hung pans

- Sigma inwall concealed cisterns are installed behind the wall in the bathroom.
- Strong, stable and easy to service: each frame is tested to withstand 400kg of weight, compliant to AS 1172.1.
- WELS 4 Star 4.5L/3L.



Available in more options, see the full collection at oliveri.com.au

*Visit oliveri.com.au for full warranty details.

Baths

Freestanding Bath

Available in two sizes:

NA1500-D
1500mm wide / 135 litres

NA1700-D
1700mm wide / 160 litres

Material: Lucite acrylic

Warranty*:
10 years replacement product
1 year labour



1500mm wide

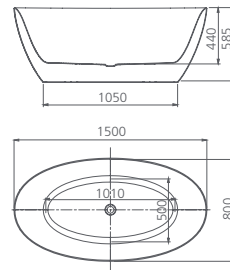

1700mm wide

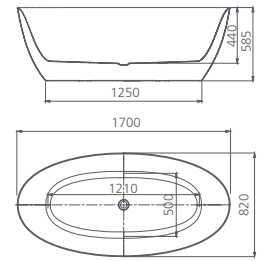

Island Bath

Available in two sizes:

MU1675
1675mm wide / 166 litres

MU1750
1750mm wide / 182 litres

Material: Premium
sanitary grade acrylic

Warranty*:
15 years replacement product, 1 year labour



1675mm wide

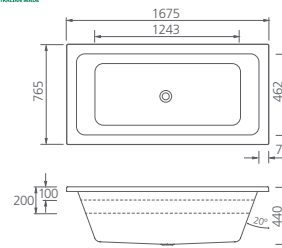

1750mm wide

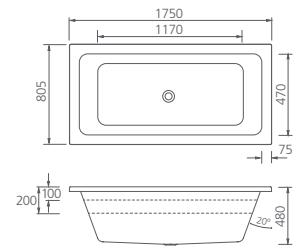

Inset Bath With Tile Bead

Available in two sizes:

NA1520
1520mm wide / 121 litres

NA1665
1665mm wide / 138 litres

Material: Premium
sanitary grade acrylic

Warranty*:
15 years replacement product, 1 year labour

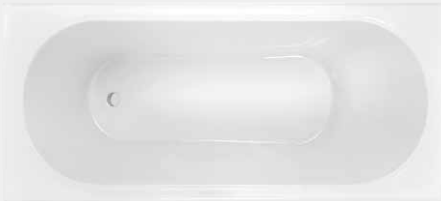

1520mm wide

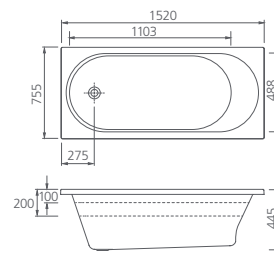

1665mm wide

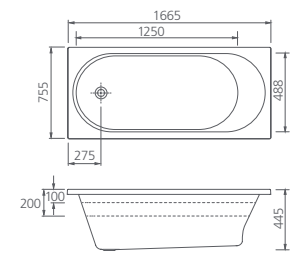

Inset Bath With Tile Bead

Available in two sizes:

DU1510
1510mm wide / 88 litres

DU1650
1650mm wide / 103 litres

Material: Premium
sanitary grade acrylic

Warranty*:
15 years replacement product
1 year labour

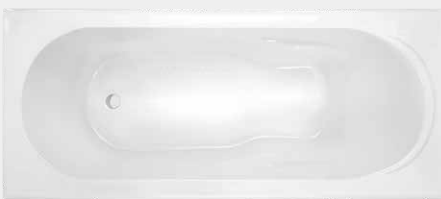

1510mm wide

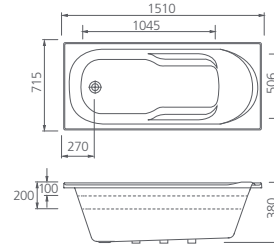

1650mm wide

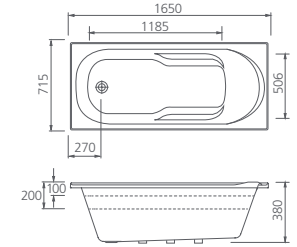

Floor Mounted Bath Filler

Chrome
VE994510CR
500kpa Max. pressure



Also available in:

● Matte black

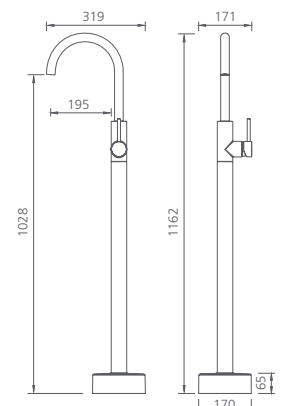

Available in more options, see the full collection at oliveri.com.au

*Visit oliveri.com.au for full warranty details.

Accessories

All accessories also available in:

- Matte black
- Gunmetal
- Brushed Nickel
- Classic Gold

Single Towel Rail

Chrome
650mm wide
 MA824C26CR
800mm wide
 MA830A26CR

Materials: Zinc alloy / stainless steel

Mounting method: Wall mounting, four point fixing

Warranty*: 7 years parts and finish, 1 year labour

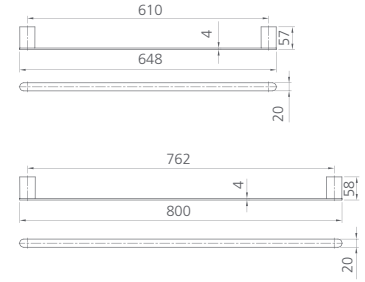

Double Towel Rail

Chrome
650mm wide
 MA824E26CR
800mm wide
 MA830B26CR

Materials: Zinc alloy / brass / stainless steel

Mounting method: Wall mounting, four point fixing

Warranty*: 7 years parts and finish, 1 year labour

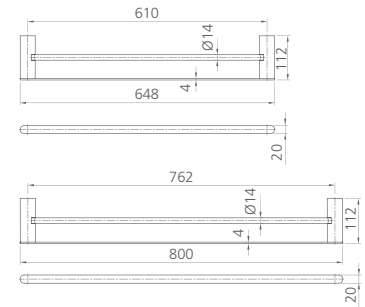

Hand Towel Rail

Chrome
 MA860D26CR

Materials: Zinc alloy / brass

Mounting method: Wall mounting, four point fixing

Warranty*: 7 years parts and finish, 1 year labour

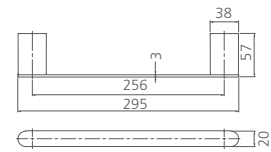

Shower Shelf

Chrome
 MA891A26CR

Materials: Zinc alloy / brass / stainless steel

Mounting method: Wall mounting, four point fixing

Warranty*: 7 years parts and finish, 1 year labour

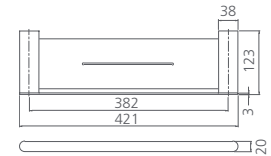

Soap Dish

Chrome
 MA859F26CR

Materials: Zinc alloy / brass / stainless steel

Mounting method: Wall mounting, four point fixing

Warranty*: 7 years parts and finish, 1 year labour

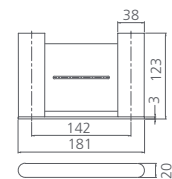

Toilet Roll Holder

Chrome
 MA855D26CR

Materials: Zinc alloy

Mounting method: Wall mounting, two point fixing

Warranty*: 7 years parts and finish, 1 year labour

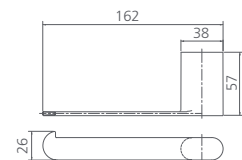

Robe Hook

Chrome
 MA854-26CR

Materials: Zinc alloy

Mounting method: Wall mounting, two point fixing

Warranty*: 7 years parts and finish, 1 year labour

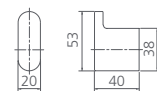

Available in more options, see the full collection at oliveri.com.au

*Visit oliveri.com.au for full warranty details.

Oliveri®

**Presenting our
Architectural Design
Specification Collection.**

An extensive range of
high quality products with
offerings for the kitchen,
laundry and bathroom.

Contact your local rep for more information.



oliveri.com.au