

Care Collection



Oliveri



We are thrilled to announce that Oliveri is expanding into care products designed specifically for people with disabilities or mobility issues. We believe that everyone deserves access to high-quality, affordable and reliable Oliveri products that meet their unique needs and preferences no matter their circumstance.

Oliveri is committed to serving the disability community by providing products that make daily living easier, more comfortable and more enjoyable without compromising on quality.

We recognise that people with disabilities face numerous challenges in their lives, including limited mobility, sensory impairments and other health conditions. We want to address these challenges by offering a range of products that are specially designed to meet the needs of people with disabilities. We have worked closely with DDA Disability Access Consultants to ensure that our products are effective, safe and user-friendly.

Our team at Oliveri is passionate about helping people with disabilities to live their lives to the fullest and we believe our Care range products can make a real difference in the lives of our customers.

Thank you for your support and trust and we hope you find this new range empowering and transformative.

| | |
|-------------------------|----|
| Kitchen sinks | 6 |
| Basins | 10 |
| Toilet suites | 14 |
| Grab rails | 22 |
| Care accessories | 32 |
| Care handles | 38 |





Kitchen sinks

Puro single bowl topmount sink with drainer

PU2820

Reversible sink

Your installer will install sink depending on which side you require your sink's bowl and drainer.

Also available with 1 taphole (PU2825)



Can be installed to
comply with **AS1428.2**

| | |
|--|--|
| Sink size | 900W x 430H mm |
| Bowl size | Main Bowl: 330W x 390H x 150D / 17L |
| Construction | 2 piece, bowls and drainer seam welded |
| Material | 304 grade, 18/10 polished stainless steel (0.8 mm thick) |
| Heat protection | Supplied with insulation pad to bottom of bowl |
| Installation | Topmount recommended |
| Fixings | Adjustable clips and sealing foam supplied |
| Min cabinet size | 500 mm |
| Tap holes | Available 0 or 1 tap hole (specify when ordering) |
| Waste fittings | 1 x 90 mm basket waste included |
| Overflow | Not available |
| Carton size | 986 x 518 x 230 mm |
| Weight | 5.0 kg |
| Warranty | Lifetime manufacturer's warranty (refer to oliveri.com.au) |
| Maintenance and care instructions | All surfaces should be cleaned with mild liquid detergent or soap and water. To maintain the shine on your Oliveri stainless steel sink, we recommended the use of any of the easy to obtain, non-abrasive stainless steel cleaners or metal polishes. |

Top view

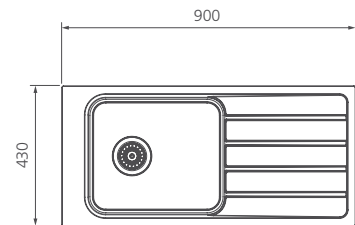

Side view

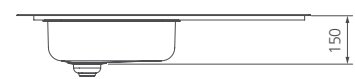

Included accessories



AC14
Basket Waste



Kitchen sinks

Puro single bowl topmount sink

PU2850

Reversible sink

Your installer will install depending on which side you require your sink's waste outlet/tap.

Also available with 1 taphole (PU2855)



Can be installed to
comply with **AS1428.2**

| | |
|--|--|
| Sink size | 580W x 430H mm |
| Bowl size | Main Bowl: 330W x 390H x 150D / 17L |
| Construction | 2 piece, bowls and drainer seam welded |
| Material | 304 grade, 18/10 polished stainless steel (0.8 mm thick) |
| Heat protection | Supplied with insulation pad to bottom of bowl |
| Installation | Topmount recommended |
| Fixings | Adjustable clips and sealing foam supplied |
| Min cabinet size | 500 mm |
| Tap holes | Available 0 or 1 tap hole (specify when ordering) |
| Waste fittings | 1 x 90 mm basket waste included |
| Overflow | Not available |
| Carton size | 666 x 518 x 230 mm |
| Weight | 4.0 kg |
| Warranty | Lifetime manufacturer's warranty (refer to oliveri.com.au) |
| Maintenance and care instructions | All surfaces should be cleaned with mild liquid detergent or soap and water. To maintain the shine on your Oliveri stainless steel sink, we recommended the use of any of the easy to obtain, non-abrasive stainless steel cleaners or metal polishes. |

Top view

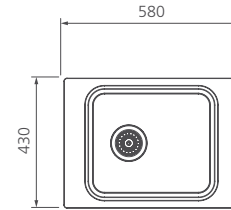

Side view

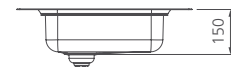

Included accessories



AC14
Basket Waste



Basins

Munich wall hung basin with shelf (left hand)

MU005WH

Colour

White



Can be installed to
comply with **AS1428.1**

| | |
|--|--|
| Tap holes | 1 tap hole |
| Waste outlet | Pop up waste sold separately |
| Overflow | Included (with plastic chrome plated overflow ring) |
| Basin size | 600W x 410H x 130D mm |
| Bowl size | 400W x 280H x 100D mm |
| Bowl capacity | 11.2L |
| Material | Vitreous china |
| Installation | Wall hung |
| Weight | 17.0kg |
| Commercial warranty | 10 years replacement parts, 1 year labour (refer to oliveri.com.au) |
| Maintenance and care instructions | All surfaces should be cleaned with mild liquid detergent or soap and water. Do not use cream cleaners or citrus based cleaning products, as they are abrasive. Use of unsuitable cleaning agents may damage the surface. Any damage caused in this way will not be covered by warranty. |

Top view

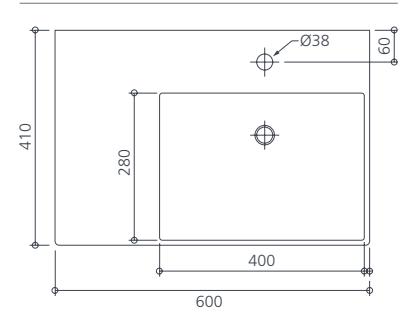

Side view

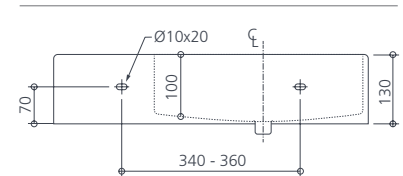

Basins

Munich wall hung basin with shelf (right hand)

MU006WH

Colour

White



Can be installed to
comply with **AS1428.1**

| | |
|--|--|
| Tap holes | 1 tap hole |
| Waste outlet | Pop up waste sold separately |
| Overflow | Included (with plastic chrome plated overflow ring) |
| Basin size | 600W x 410H x 130D mm |
| Bowl size | 400W x 280H x 100D mm |
| Bowl capacity | 11.2L |
| Material | Vitreous china |
| Installation | Wall hung |
| Weight | 17.0kg |
| Commercial warranty | 10 years replacement parts, 1 year labour (refer to oliveri.com.au) |
| Maintenance and care instructions | All surfaces should be cleaned with mild liquid detergent or soap and water. Do not use cream cleaners or citrus based cleaning products, as they are abrasive. Use of unsuitable cleaning agents may damage the surface. Any damage caused in this way will not be covered by warranty. |

Top view

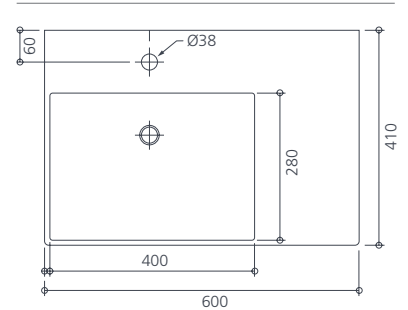

Side view

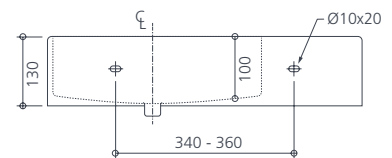

Toilet suites

Vienna back to wall care toilet suite with grey seat and buttons

Full suite: VI201C-G

Pan: VI201C-P

Cistern: VI201C-C

Seat: ACC201-4CG

Buttons: ACC201-7CG

WELs Rating

4 star, 3.5L avg flush volume

Colours

White / Grey seat



Can be installed to
comply with **AS1428.1**

| | |
|--|--|
| Pan | Rimless/Easy-clean design |
| Trap(s) | Universal trap for S or P-trap installations. S-trap set out 140mm - 250mm as standard. P-trap set out 180mm floor to centre of outlet. |
| Cistern | R&T dual flush cistern (4.5L/3L) with raised grey cistern buttons |
| Fixing | The cistern is fixed directly to the pan with a robust concealed base fixing. |
| Seat | Lock-in single flap grey toilet seat is provided as standard. UF compression moulded toilet seat, fitted with buffers and metal hinges. |
| Installation | AS1428 Compliance: Refer to the latest standard to ensure installation meets the requirements. The installation of the toilet suite shall be in accordance with the normal minimum drain line grade requirements in AS/ NZS 3500.2 |
| Materials | Vitreous china |
| Weight | Pan 44.1kg, cistern 14.2kg |
| Parts list | Pan, cistern, buttons, seat, hinges, S-trap connector, seal ring, fixing plate, fixing screw, floor fixing screw |
| Commercial warranty | 10 years vitreous china cistern and pan replacement of product; 5 years replacement seat; 2 years valves and fittings; 1 year seals, buttons and labour (refer to oliveri.com.au) |
| Maintenance and care instructions | All surfaces should be cleaned with mild liquid detergent or soap and water. Do not use cream cleaners or citrus based cleaning products, as they are abrasive. Use of unsuitable cleaning agents may damage the surface. Any damage caused in this way will not be covered by warranty. |

Front view

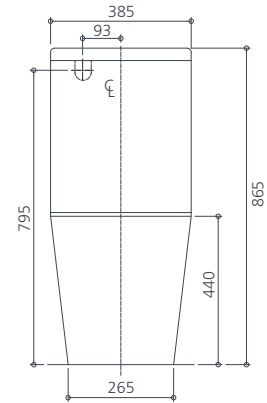

Top view

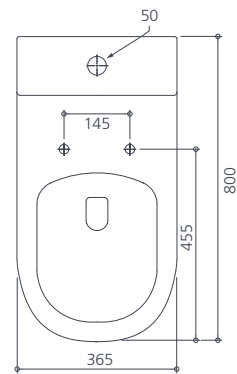

Side view

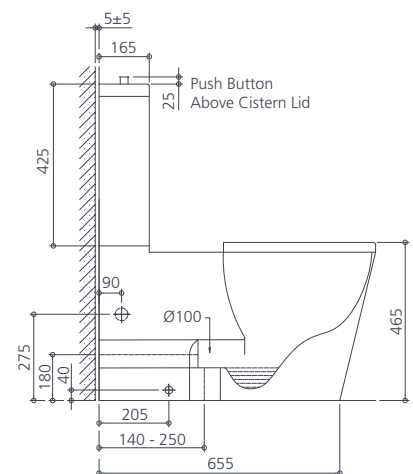

Toilet suites

Vienna back to wall care toilet suite with blue seat and buttons

Full suite: VI201C-B

Pan: VI201C-P

Cistern: VI201C-C

Seat: ACC201-6CB

Buttons: ACC201-8CB

WELs Rating

4 star, 3.5L avg flush volume

Colours

White / Blue seat



Can be installed to
comply with **AS1428.1**

| | |
|--|--|
| Pan | Rimless/Easy-clean design |
| Trap(s) | Universal trap for S or P-trap installations. S-trap set out 140mm - 250mm as standard. P-trap set out 180mm floor to centre of outlet. |
| Cistern | R&T dual flush cistern (4.5L/3L) with raised blue cistern buttons |
| Fixing | The cistern is fixed directly to the pan with a robust concealed base fixing. |
| Seat | Lock-in single flap blue toilet seat is provided as standard. UF compression moulded toilet seat, fitted with buffers and metal hinges. |
| Colours | White / blue seat |
| Installation | AS1428 Compliance: Refer to the latest standard to ensure installation meets the requirements. The installation of the toilet suite shall be in accordance with the normal minimum drain line grade requirements in AS/ NZS 3500.2 |
| Materials | Vitreous china |
| Weight | Pan 44.1kg, cistern 14.2kg |
| Parts list | Pan, cistern, buttons, seat, hinges, S-trap connector, seal ring, fixing plate, fixing screw, floor fixing screw |
| Commercial warranty | 10 years vitreous china cistern and pan replacement of product; 5 years replacement seat; 2 years valves and fittings; 1 year seals, buttons and labour (refer to oliveri.com.au) |
| Maintenance and care instructions | All surfaces should be cleaned with mild liquid detergent or soap and water. Do not use cream cleaners or citrus based cleaning products, as they are abrasive. Use of unsuitable cleaning agents may damage the surface. Any damage caused in this way will not be covered by warranty. |

Front view

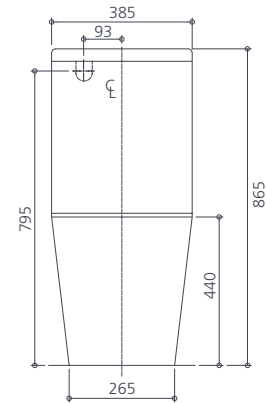

Top view

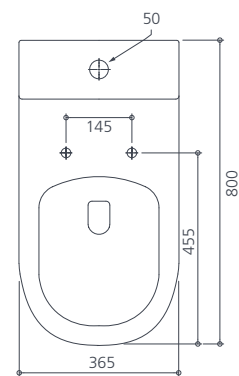

Side view

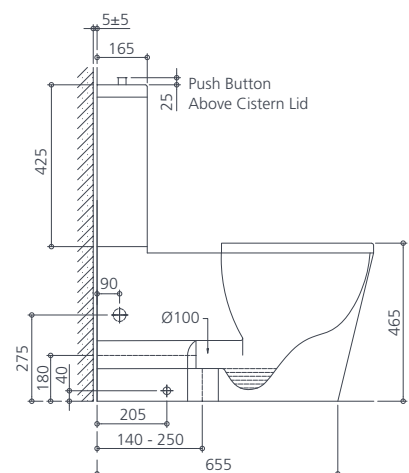

Toilet suites

Vienna wall faced care toilet suite with grey seat

Full suite: VI202C-G

Pan: VI202C

Cistern: ACCIWRTC

Seat: ACC201-4CG

Suite includes

- Rimless Pan
- Lock-in, single flap grey seat
- R&T dual flush concealed cistern
- Brushed chrome raised button push plate
- Fittings & fixtures

WELs Rating

4 star, 3.5L avg flush volume

Colours

White / Grey seat

Push plate

Brushed chrome raised button push plate



Can be installed to comply with **AS1428.1**

| | |
|--|--|
| Pan | Box rimless design |
| Trap(s) | Universal trap for S or P-trap installations. S-trap set out 140mm - 250mm as standard. P-trap set out 180mm floor to centre of outlet. |
| Cistern | R&T dual flush concealed cistern (4.5L/3L, 3.5L avg flush volume) |
| Flush plate | Brushed chrome raised pneumatic buttons - AS 1428.1 compliant |
| Fixing | The toilet is fixed with R&T concealed water tank in wall. |
| Seat | Lock-in single flap grey toilet seat is provided as standard. UF compression moulded toilet seat, fitted with buffers and metal hinges. |
| Installation | AS1428 Compliance: Refer to the latest standard to ensure installation meets the requirements. The installation of the toilet suite shall be in accordance with the normal minimum drain line grade requirements in AS/ NZS 3500.2 |
| Materials | Vitreous china |
| Weight | Pan 44.1kg, cistern 7.0kg |
| Parts list | Pan, seat, hinges, concealed cistern, push plate, S-trap connector, seal ring, fixing plate, fixing screw, floor fixing screw |
| Commercial warranty | 10 years vitreous china pan replacement of product; 5 years replacement seat, cistern; 2 years valves and fittings; 1 year seals, buttons and labour (refer to oliveri.com.au) |
| Maintenance and care instructions | All surfaces should be cleaned with mild liquid detergent or soap and water. Do not use cream cleaners or citrus based cleaning products, as they are abrasive. Use of unsuitable cleaning agents may damage the surface. Any damage caused in this way will not be covered by warranty. |

Front view

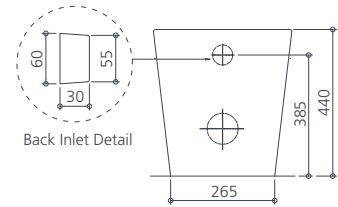

Top view

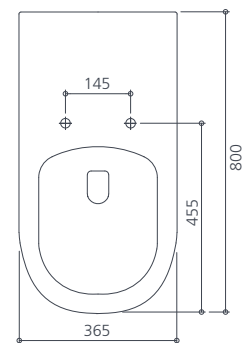

Side view

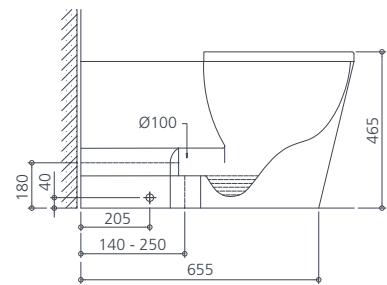

Toilet suites

Vienna wall faced care toilet suite with blue seat

Full suite: VI202C-B

Pan: VI202C

Cistern: ACCIWRTC

Seat: ACC201-6CB

Suite includes

- Rimless Pan
- Lock-in, single flap grey seat
- R&T dual flush concealed cistern
- Brushed chrome raised button push plate
- Fittings & fixtures

WELs Rating

4 star, 3.5L avg flush volume

Colours

White / Blue seat

Push plate

Brushed chrome raised button push plate



Can be installed to comply with **AS1428.1**

| | |
|--|--|
| Pan | Box rimless design |
| Trap(s) | Universal trap for S or P-trap installations. S-trap set out 140mm - 250mm as standard. P-trap set out 180mm floor to centre of outlet |
| Cistern | R&T dual flush concealed cistern (4.5L/3L, 3.5L avg flush volume) |
| Flush plate | Brushed chrome raised pneumatic buttons - AS 1428.1 compliant |
| Fixing | The toilet is fixed with R&T concealed water tank in wall |
| Seat | Lock-in single flap blue toilet seat is provided as standard. UF compression moulded toilet seat, fitted with buffers and metal hinges |
| Installation | AS1428 Compliance: Refer to the latest standard to ensure installation meets the requirements. The installation of the toilet suite shall be in accordance with the normal minimum drain line grade requirements in AS/ NZS 3500.2 |
| Materials | Vitreous china |
| Weight | Pan 44.1kg, cistern 7.0kg |
| Parts list | Pan, seat, hinges, concealed cistern, push plate, S-trap connector, seal ring, fixing plate, fixing screw, floor fixing screw |
| Commercial warranty | 10 years vitreous china pan replacement of product; 5 years replacement seat, cistern; 2 years valves and fittings; 1 year seals, buttons and labour (refer to oliveri.com.au) |
| Maintenance and care instructions | All surfaces should be cleaned with mild liquid detergent or soap and water. Do not use cream cleaners or citrus based cleaning products, as they are abrasive. Use of unsuitable cleaning agents may damage the surface. Any damage caused in this way will not be covered by warranty. |

Front view

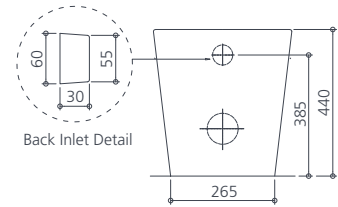

Top view

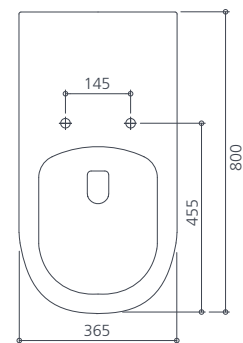

Side view

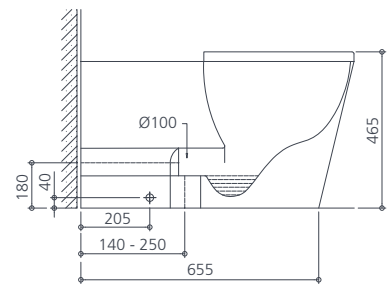

Grab rails

Holdfast straight grab rail

300mm

HF823-300

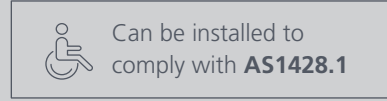

| | |
|--|--|
| Rail size | Diameter 32mm |
| Application | Domestic and commercial care |
| Fixing | Brass base and connector with secure flange pin and cover to conceal wall fixings |
| Installation | Can be installed to comply with AS1428.1 (load rating > 1100 N) |
| Materials | Satin stainless steel 304 (1.2mm thick railing tube) |
| Weight | 0.7kg |
| Parts list | Grab rail, flange covers and fixings |
| Commercial warranty | 15 years replacement parts and 1 year labour (refer to oliveri.com.au) |
| Maintenance and care instructions | All surfaces should be cleaned with mild liquid detergent or soap and water. Do not use cream cleaners or citrus based cleaning products, as they are abrasive. Use of unsuitable cleaning agents may damage the surface. Any damage caused in this way will not be covered by warranty. |

Front view

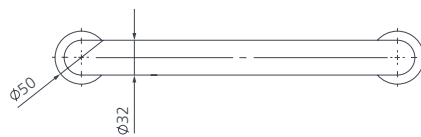

Concealed brass fixing mechanism

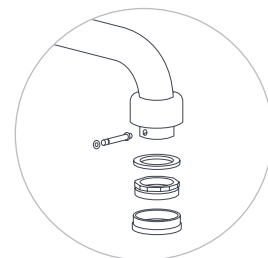

Side view

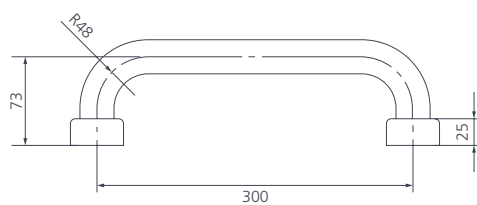

Grab rails

Holdfast straight grab rail

600mm

HF823-600

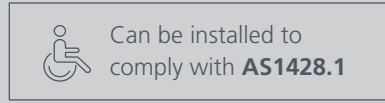

| | |
|--|--|
| Rail size | Diameter 32mm |
| Application | Domestic and commercial care |
| Fixing | Brass base and connector with secure flange pin and cover to conceal wall fixings |
| Installation | Can be installed to comply with AS1428.1 (load rating > 1100 N) |
| Materials | Satin stainless steel 304 (1.2mm thick railing tube) |
| Weight | 1.0kg |
| Parts list | Grab rail, flange covers and fixings |
| Commercial warranty | 15 years replacement parts and 1 year labour (refer to oliveri.com.au) |
| Maintenance and care instructions | All surfaces should be cleaned with mild liquid detergent or soap and water. Do not use cream cleaners or citrus based cleaning products, as they are abrasive. Use of unsuitable cleaning agents may damage the surface. Any damage caused in this way will not be covered by warranty. |

Front view

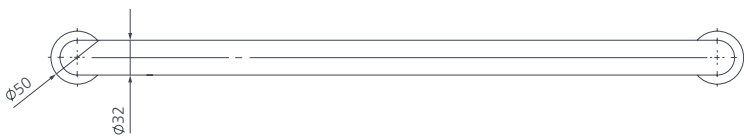

Concealed brass fixing mechanism

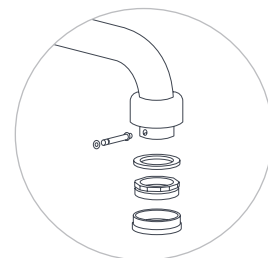

Side view

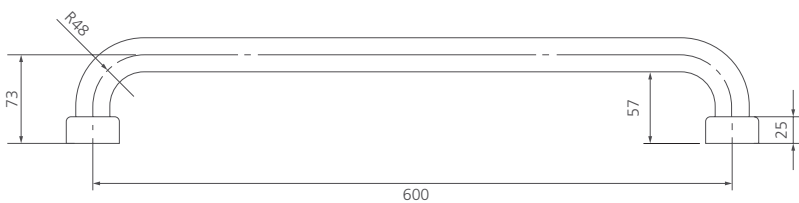

Grab rails

Holdfast straight grab rail

900mm

HF823-900

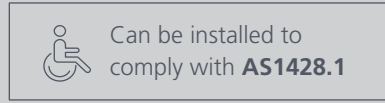

| | |
|--|--|
| Rail size | Diameter 32mm |
| Application | Domestic and commercial care |
| Fixing | Brass base and connector with secure flange pin and cover to conceal wall fixings |
| Installation | Can be installed to comply with AS1428.1 (load rating > 1100 N) |
| Materials | Satin stainless steel 304 (1.2mm thick railing tube) |
| Weight | 1.3kg |
| Parts list | Grab rail, flange covers and fixings |
| Commercial warranty | 15 years replacement parts and 1 year labour (refer to oliveri.com.au) |
| Maintenance and care instructions | All surfaces should be cleaned with mild liquid detergent or soap and water. Do not use cream cleaners or citrus based cleaning products, as they are abrasive. Use of unsuitable cleaning agents may damage the surface. Any damage caused in this way will not be covered by warranty. |

Front view



Concealed brass fixing mechanism

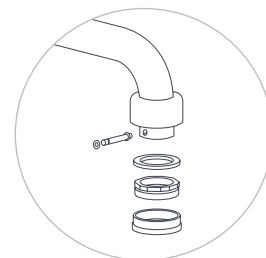

Side view



Grab rails

Holdfast vertical lock grab rail

HF814

 Can be installed to comply with **AS1428.1**



| | |
|--|--|
| Rail size | Diameter 32mm |
| Application | Domestic and commercial care |
| Fixing | 5 x fixing points (wall plug and screws supplied) |
| Installation | Can be installed to comply with AS1428.1 (load rating > 1100 N) |
| Materials | Satin stainless steel 304 (1.2mm thick railing tube) |
| Weight | 2.4kg |
| Parts list | Grab rail, fixings |
| Commercial warranty | 15 years replacement parts and 1 year labour (refer to oliveri.com.au) |
| Maintenance and care instructions | All surfaces should be cleaned with mild liquid detergent or soap and water. Do not use cream cleaners or citrus based cleaning products, as they are abrasive. Use of unsuitable cleaning agents may damage the surface. Any damage caused in this way will not be covered by warranty. |

Front view

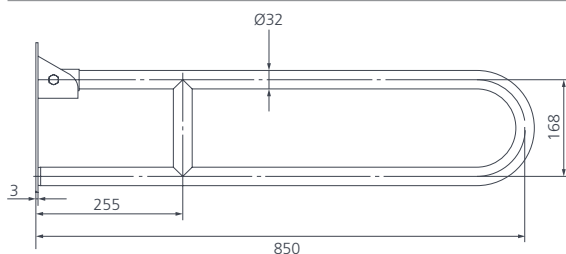

Side view

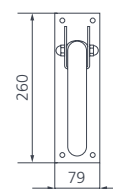

Grab rails

Holdfast inverted T shower rail (left and right hand available)



Can be installed to
comply with **AS1428.1**

HF871-LH
HF871-RH



| | |
|--|--|
| Rail size | Diameter 32mm grip and shower rail |
| Options | Left and Right hand versions available Compatible with Rome Care Shower Kit (RO111C-CR) |
| Application | Domestic and commercial care |
| Fixing | Brass base and connector with secure flange pin and cover to conceal wall fixings |
| Installation | Can be installed to comply with AS1428.1 (load rating > 1100 N) |
| Materials | Satin stainless steel 304 (1.2mm thick railing tube) |
| Weight | 2.4kg |
| Parts list | Grab rail, flange covers and fixings |
| Commercial warranty | 15 years replacement parts and 1 year labour (refer to oliveri.com.au) |
| Maintenance and care instructions | All surfaces should be cleaned with mild liquid detergent or soap and water. Do not use cream cleaners or citrus based cleaning products, as they are abrasive. Use of unsuitable cleaning agents may damage the surface. Any damage caused in this way will not be covered by warranty. |

Front view (left hand)

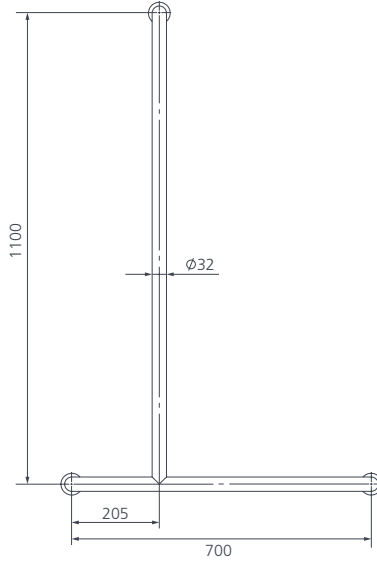

Front view (right hand)

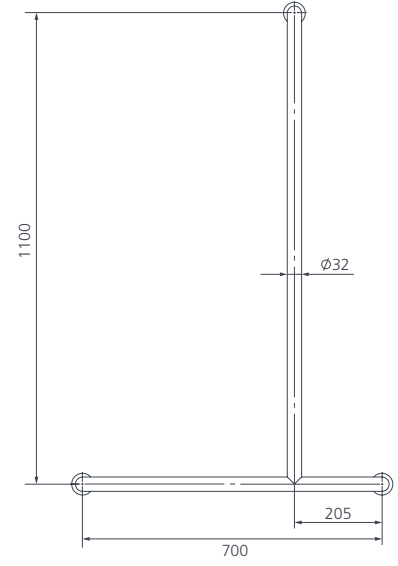

Side view

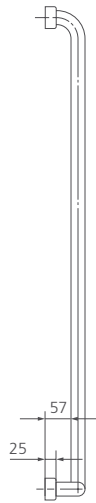

Concealed brass fixing mechanism

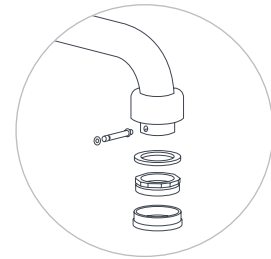

Grab rails

Holdfast 90 Degree grab rail

(left and right hand available)

HF817-LH

HF817-RH



Can be installed to comply with **AS1428.1**

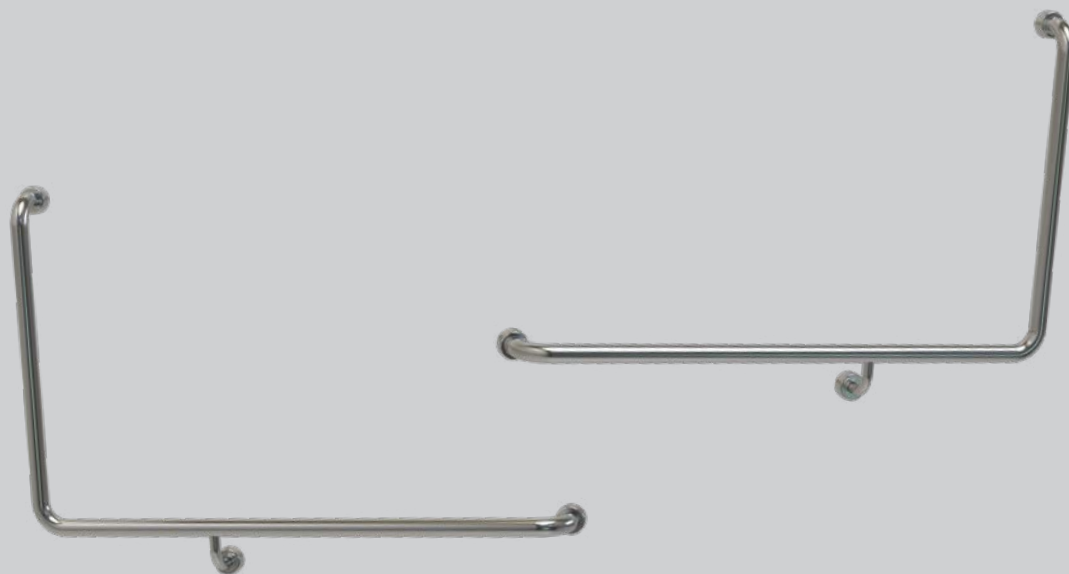

| | |
|--|--|
| Rail size | Diameter 32mm |
| Application | Domestic and commercial care |
| Options | Left and Right hand versions available |
| Fixing | Brass base and connector with secure flange pin and cover to conceal wall fixings. |
| Installation | Can be installed to comply with AS1428.1 (load rating > 1100 N) |
| Materials | Satin stainless steel 304 (1.2mm thick railing tube) |
| Weight | 2.1kg |
| Parts list | Grab rail, flange covers and fixings |
| Commercial warranty | 15 years replacement parts and 1 year labour (refer to oliveri.com.au) |
| Maintenance and care instructions | All surfaces should be cleaned with mild liquid detergent or soap and water. Do not use cream cleaners or citrus based cleaning products, as they are abrasive. Use of unsuitable cleaning agents may damage the surface. Any damage caused in this way will not be covered by warranty. |

Front view (left hand)

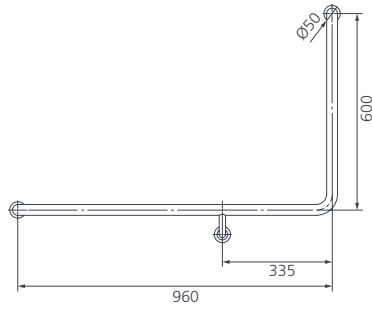

Front view (right hand)

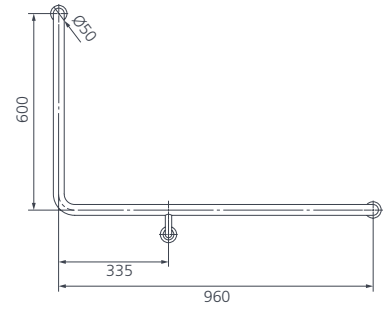

Side view (left hand)

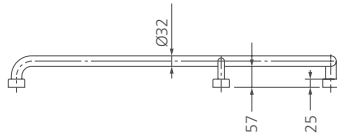

Side view (right hand)

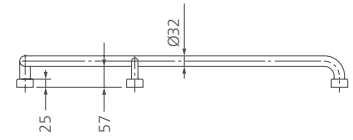

Concealed brass fixing mechanism

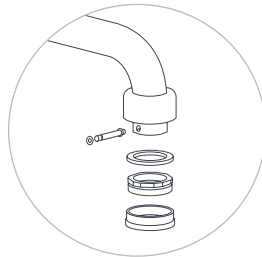

Grab rails

Holdfast 135 Degree grab rail

(left and right hand available)

HF819-LH

HF819-RH



Can be installed to comply with **AS1428.1**

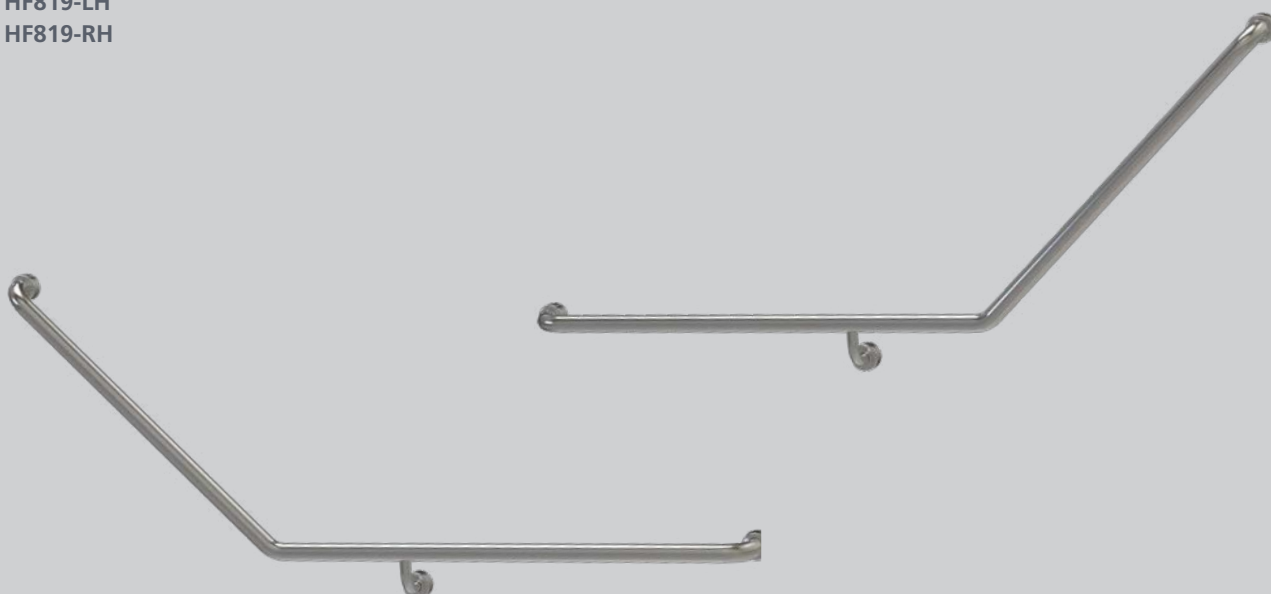

| | |
|--|--|
| Rail size | Diameter 32mm |
| Application | Domestic and commercial care |
| Options | Left and Right hand versions available |
| Fixing | Brass base and connector with secure flange pin and cover to conceal wall fixings |
| Installation | Can be installed to comply with AS1428.1 (load rating > 1100 N) |
| Materials | Satin stainless steel 304 (1.2mm thick railing tube) |
| Weight | 2.1kg |
| Parts list | Grab rail, flange covers and fixings |
| Commercial warranty | 15 years replacement parts and 1 year labour (refer to oliveri.com.au) |
| Maintenance and care instructions | All surfaces should be cleaned with mild liquid detergent or soap and water. Do not use cream cleaners or citrus based cleaning products, as they are abrasive. Use of unsuitable cleaning agents may damage the surface. Any damage caused in this way will not be covered by warranty. |

Front View (left hand)

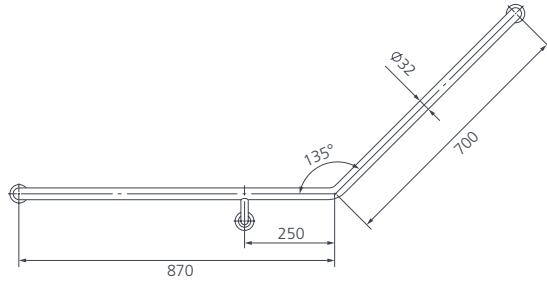

Side View (left hand)

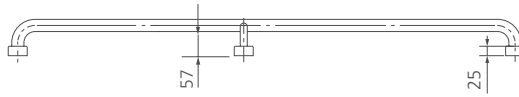

Front View (right hand)

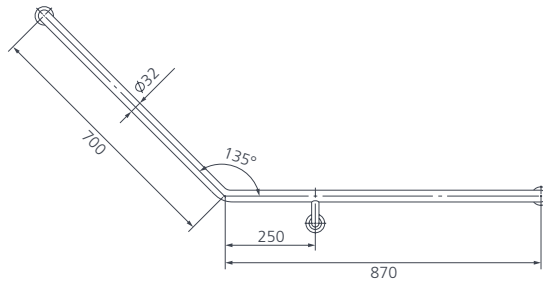

Side view (right hand)

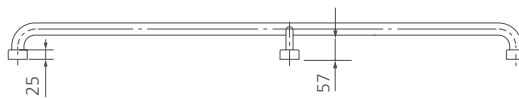

Concealed brass fixing mechanism

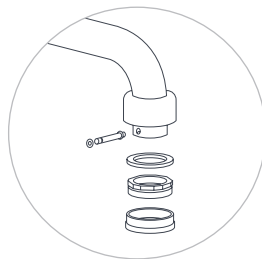

Care accessories

Folding care shower seat

ACCHF02C



Can be installed to comply with **AS1428.1**



| | |
|--|--|
| Application | Domestic and commercial care |
| Rating | Maximum load rating 120kg |
| Installation | Wall mounted. Seat can be folded up against the wall when not in use. Can be installed to comply with AS1428.1 |
| Materials | Satin stainless steel 304 frame White WPC seat slats with rounded edges and slip-resistant surface. |
| Weight | 8.6kg |
| Parts list | Frame, seat, all fixings (some assembly required) |
| Commercial warranty | 5 years replacement parts and 1 year labour (refer to oliveri.com.au) |
| Maintenance and care instructions | All surfaces should be cleaned with mild liquid detergent or soap and water. Do not use cream cleaners or citrus based cleaning products, as they are abrasive. Use of unsuitable cleaning agents may damage the surface. Any damage caused in this way will not be covered by warranty. |

Top view

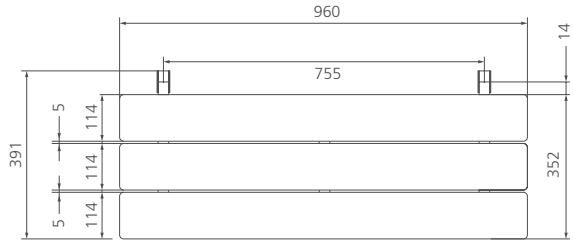

Side view

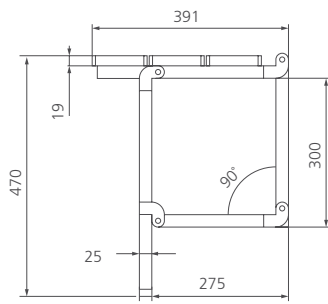

Care accessories

Care toilet

back rest

ACCBRRC

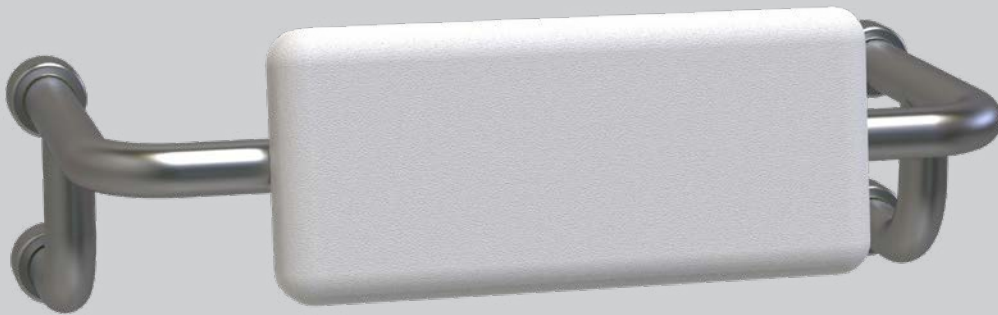

Can be installed to
comply with **AS1428.1**

| | |
|--|--|
| Rail size | Diameter 32mm |
| Application | Domestic and commercial care |
| Fixing | Brass base and connector with secure flange pin and cover to conceal wall fixings |
| Installation | Wall mounted. Can be installed to comply with AS1428.1 |
| Materials | Satin stainless steel 304 (1.2mm thick railing tube) Polyethene cushion |
| Weight | 3.2kg |
| Parts list | Backrest, flange covers and fixings |
| Commercial warranty | years replacement parts and 1 year labour (refer to oliveri.com.au) |
| Maintenance and care instructions | All surfaces should be cleaned with mild liquid detergent or soap and water. Do not use cream cleaners or citrus based cleaning products, as they are abrasive. Use of unsuitable cleaning agents may damage the surface. Any damage caused in this way will not be covered by warranty. |

Front view

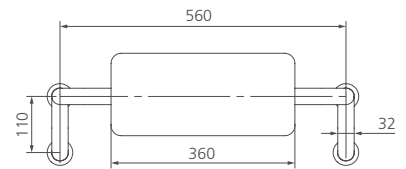

Side view

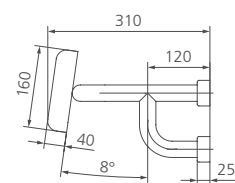

Care accessories

Vienna lock-in single flap grey care toilet seat

ACC201-4CG



Top view

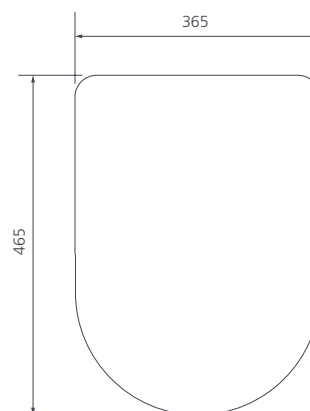

Seat view

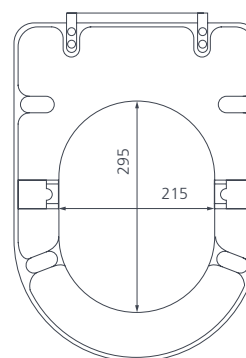

| | |
|--|--|
| Application | Domestic and commercial care |
| Options | Blue version also available |
| Fixing | Supplied with snap toggles for installation to pan |
| Installation | Can be installed to comply with AS1428.1 |
| Materials | UF compression moulded seat; stainless steel 304 hinges |
| Weight | 1.8kg |
| Parts list | Seat, hinges, hinge covers and fixings |
| Commercial warranty | 5 years replacement parts and 1 year labour (refer to oliveri.com.au) |
| Maintenance and care instructions | All surfaces should be cleaned with mild liquid detergent or soap and water. Do not use cream cleaners or citrus based cleaning products, as they are abrasive. Use of unsuitable cleaning agents may damage the surface. Any damage caused in this way will not be covered by warranty. |

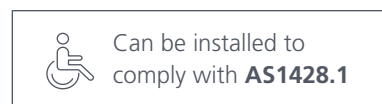

Care accessories

Vienna lock-in single flap blue care toilet seat

ACC201-6CB



Top view

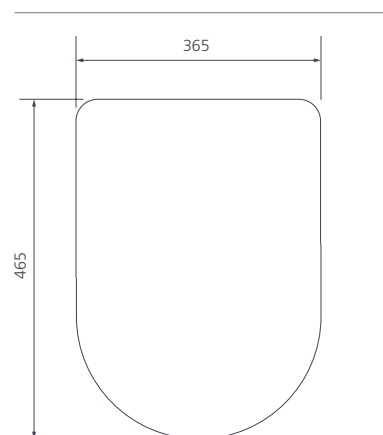

Seat view

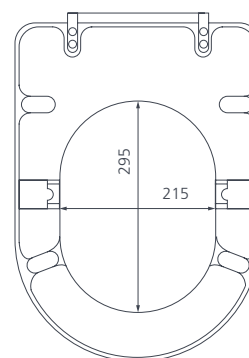

| | |
|--|--|
| Application | Domestic and commercial care |
| Options | Grey version also available |
| Fixing | Supplied with snap toggles for installation to pan |
| Installation | Can be installed to comply with AS1428.1 |
| Materials | UF compression moulded seat; stainless steel 304 hinges |
| Weight | 1.8kg |
| Parts list | Seat, hinges, hinge covers and fixings |
| Commercial warranty | 5 years replacement parts and 1 year labour (refer to oliveri.com.au) |
| Maintenance and care instructions | All surfaces should be cleaned with mild liquid detergent or soap and water. Do not use cream cleaners or citrus based cleaning products, as they are abrasive. Use of unsuitable cleaning agents may damage the surface. Any damage caused in this way will not be covered by warranty. |

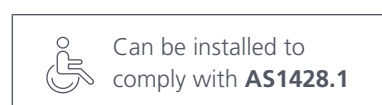

Care handles

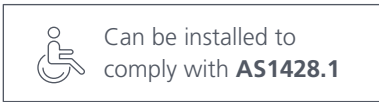

Venice care handle pin lever suit 25mm basin mixer

Chrome **SPB0227**

Compatible tapware models:

- VE103500CR Venice Curved Basin Mixer
- VE104500CR Venice Curved Tower Basin Mixer
- VE106500CR Venice Straight Basin Mixer
- VE107500CR Venice Straight Tower Basin Mixer
- VE109500CR Venice Uplift Basin Mixer
- VE110500CR Venice Uplift Tower Basin Mixer

Also available in:

 Brushed nickel **SPB0252**

Compatible tapware models:

- VE103504BN Venice Curved Basin Mixer
- VE104504BN Venice Curved Tower Basin Mixer
- VE106504BN Venice Straight Basin Mixer
- VE107504BN Venice Straight Tower Basin Mixer
- VE109504BN Venice Uplift Basin Mixer
- VE110504BN Venice Uplift Tower Basin Mixer

 Gunmetal **SPB0254**

- VE103505GM Venice Curved Basin Mixer
- VE104505GM Venice Curved Tower Basin Mixer
- VE106505GM Venice Straight Basin Mixer
- VE107505GM Venice Straight Tower Basin Mixer
- VE109505GM Venice Uplift Basin Mixer
- VE110505GM Venice Uplift Tower Basin Mixer

 Matte black **SPB0228**

- VE103506MB Venice Curved Basin Mixer
- VE104506MB Venice Curved Tower Basin Mixer
- VE106506MB Venice Straight Basin Mixer
- VE107506MB Venice Straight Tower Basin Mixer
- VE109506MB Venice Uplift Basin Mixer
- VE110506MB Venice Uplift Tower Basin Mixer

 Classic gold **SPB0256**

- VE103503CG Venice Curved Basin Mixer
- VE104503CG Venice Curved Tower Basin Mixer
- VE106503CG Venice Straight Basin Mixer
- VE107503CG Venice Straight Tower Basin Mixer
- VE109503CG Venice Uplift Basin Mixer
- VE110503CG Venice Uplift Tower Basin Mixer

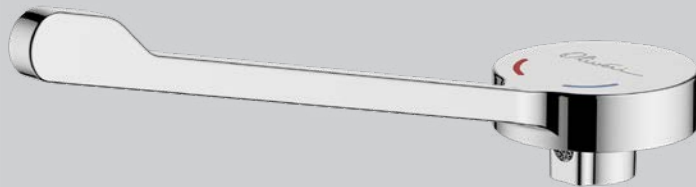

| | |
|----------------------------|--|
| Style | Extended lever length handle |
| Compatible tapware | Oliveri Venice basin mixers |
| Finish | Chrome, Brushed nickel, Gunmetal, Matte black and Classic gold |
| Materials | Zinc casting |
| Weight | 0.09kg |
| Commercial warranty | 15 years part, 10 years finish, 1 year labour (refer to oliveri.com.au) |

Maintenance and care instructions

All surfaces should be cleaned with mild liquid detergent or soap and water. Do not use cream cleaners or citrus based cleaning products, as they are abrasive. Use of unsuitable cleaning agents may damage the surface. Any damage caused in this way will not be covered by warranty.

Top view

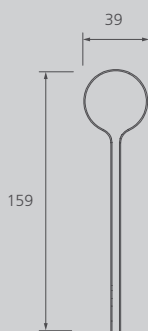

Side view

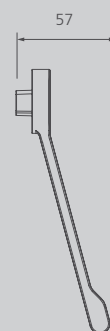

Care handles

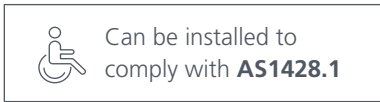

Venice care handle pin lever suit 35mm wall mixer

Chrome **SPB0229**

Compatible tapware models:

- VE111504BN Venice Wall Mixer
- VE112504BN Venice Wall Mixer with Diverter
- VE105504BN Venice Curved Wall Mixer Set
- VE108504BN Venice Straight Wall Mixer Set

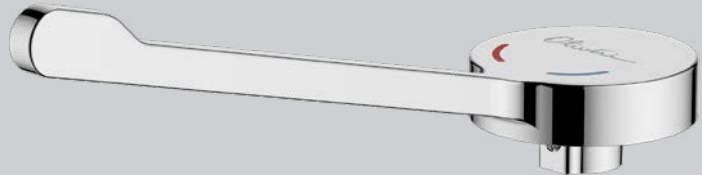

Also available in:

 Brushed nickel **SPB0252**

Compatible tapware models:

- VE111504BN Venice Wall Mixer
- VE112504BN Venice Wall Mixer with Diverter
- VE105504BN Venice Curved Wall Mixer Set
- VE108504BN Venice Straight Wall Mixer Set

 Gunmetal **SPB0254**

- VE111505GM Venice Wall Mixer
- VE112505GM Venice Wall Mixer with Diverter
- VE105505GM Venice Curved Wall Mixer Set
- VE108505GM Venice Straight Wall Mixer Set

 Matte black **SPB0228**

- VE111516MB Venice Wall Mixer
- VE112516MB Venice Wall Mixer with Diverter
- VE105516MB Venice Curved Wall Mixer Set
- VE108516MB Venice Straight Wall Mixer Set

 Classic gold **SPB0256**

- VE111503CG Venice Wall Mixer
- VE112503CG Venice Wall Mixer with Diverter
- VE105503CG Venice Curved Wall Mixer Set
- VE108503CG Venice Straight Wall Mixer Set

| | |
|--|--|
| Style | Extended lever length handle |
| Compatible tapware | Oliveri Venice wall mixers |
| Finish | Chrome, Brushed nickel, Gunmetal, Matte black and Classic gold |
| Materials | Zinc casting |
| Weight | 0.09kg |
| Commercial warranty | 15 years part, 10 years finish, 1 year labour (refer to oliveri.com.au) |
| Maintenance and care instructions | All surfaces should be cleaned with mild liquid detergent or soap and water. Do not use cream cleaners or citrus based cleaning products, as they are abrasive. Use of unsuitable cleaning agents may damage the surface. Any damage caused in this way will not be covered by warranty. |

Top view

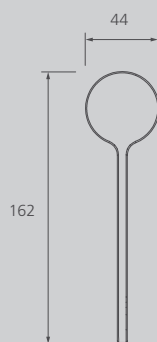

Side view



Care handles

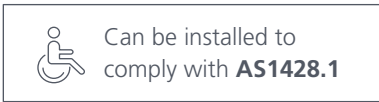

Essente care handle for goose neck mixer

Stainless steel **ACCH001**

Compatible tapware models:

- SS2520 Essente Stainless Steel Goose Neck Mixer
- SS2525 Essente Stainless Steel Goose Neck Pull Out Mixer
- SS2570 Essente Stainless Steel Square Goose Neck Mixer
- SS2575 Essente Stainless Steel Square Goose Neck Pull Out Mixer

Also available in:

 Gunmetal **ACCH004**

Compatible tapware models:

- SS2525-GM Essente Gunmetal Goose Neck Pull Out Mixer
- SS2575-GM Essente Gunmetal Square Goose Neck Pull Out Mixer

 Matte black **ACCH003**

- SS2525-BL Essente Black Goose Neck Pull Out Mixer
- SS2575-BL Essente Black Square Goose Neck Pull Out Mixer

 Brushed gold **ACCH002**

- SS2525-AU Essente Brushed Gold Goose Neck Pull Out Mixer
- SS2575-AU Essente Brushed Gold Square Goose Neck Pull Out Mixer



Top view

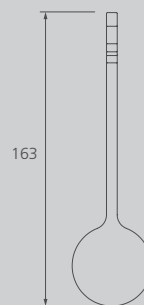

Side view

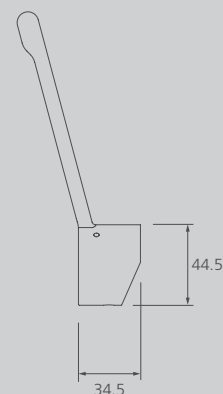

| | |
|--|--|
| Style | Extended lever length handle |
| Compatible tapware | Oliveri Essente goose neck mixers |
| Finish | Natural (stainless steel), Gunmetal, Matte black and Brushed gold |
| Materials | 304 Grade stainless steel |
| Weight | 0.14kg |
| Commercial warranty | 7 years part, 1 year labour (5 years finish: PVD finishes only) (refer to oliveri.com.au) |
| Maintenance and care instructions | All surfaces should be cleaned with mild liquid detergent or soap and water. Do not use cream cleaners or citrus based cleaning products, as they are abrasive. Use of unsuitable cleaning agents may damage the surface. Any damage caused in this way will not be covered by warranty. |

Care handles



Can be installed to comply with **AS1428.1**

Essente care handle for swivel mixer

ACCH005

Compatible tapware models:

SS2510 Essente Stainless Steel Swivel Mixer

SS2515 Essente Stainless Steel Swivel Pull Out Mixer



Top view



Side view

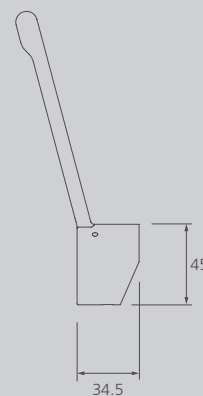

| | |
|--|--|
| Style | Extended lever length handle |
| Compatible tapware | Oliveri Essente swivel mixers |
| Finish | Natural (stainless steel) |
| Materials | 304 Grade stainless steel |
| Weight | 0.14kg |
| Commercial warranty | 7 years part, 1 year labour (refer to oliveri.com.au) |
| Maintenance and care instructions | All surfaces should be cleaned with mild liquid detergent or soap and water. Do not use cream cleaners or citrus based cleaning products, as they are abrasive. Use of unsuitable cleaning agents may damage the surface. Any damage caused in this way will not be covered by warranty. |



Oliveri Solutions Pty Ltd

Oliveri

oliveri.com.au