

# Naples

NA1700-D

Freestanding Bath 1700mm



All dimensions in mm

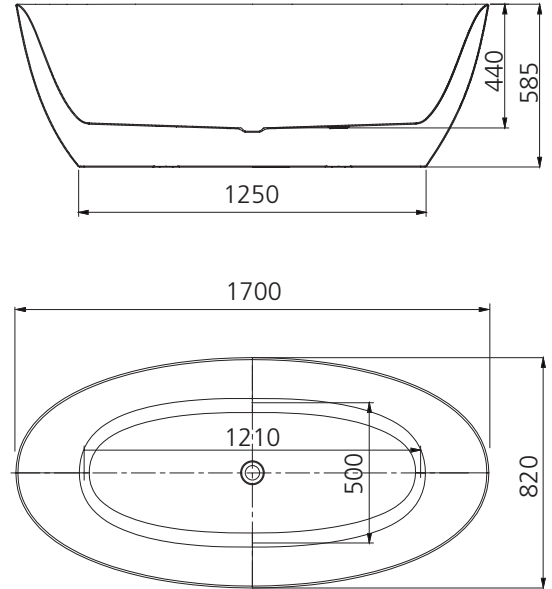

## Specifications /

<b>Dimensions</b>	1700 W x 820 H x 585 D mm
<b>Capacity</b>	160 L (200 mm below rim)
<b>Weight</b>	48 kg
<b>Installation</b>	Freestanding
<b>Construction</b>	2 piece with seamless finish
<b>Material</b>	Lucite acrylic
<b>Finish</b>	High gloss
<b>Colour</b>	White
<b>Waste outlet</b>	Not included (waste hole diameter 52 mm)
<b>Overflow</b>	Not available
<b>Carton size</b>	1750 W x 600 H x 820 D mm
<b>Warranty</b>	10 years replacement product, 1 year labour (see Oliveri website for full details)
<b>Maintenance and care instructions</b>	All surfaces should be cleaned with mild liquid detergent or soap and water. Do not use cream cleaners or citrus based cleaning products, as they are abrasive. Use of unsuitable cleaning agents may damage the surface. Any damage caused in this way will not be covered by warranty.