



Model No: 863-1

800 Series

Product Specifications

TOP MOUNT SELF-RIM SINK

www.oliverisinks.com

MATERIAL

Stainless Steel
304 Grade
18 Gauge

CONSTRUCTION

Individual bowls
welded into rim

SHIPPING WEIGHT

(Packed)
31.0 lb

INSTALLATION METHOD

Designed to be
top mounted or
undermounted

CABINET

Minimum
36"

WARRANTY

All Oliveri sinks carry
Tasman sinkware's
Lifetime Limited
Buyer Warranty



Model No: 863-1 SINK DIMENSIONS

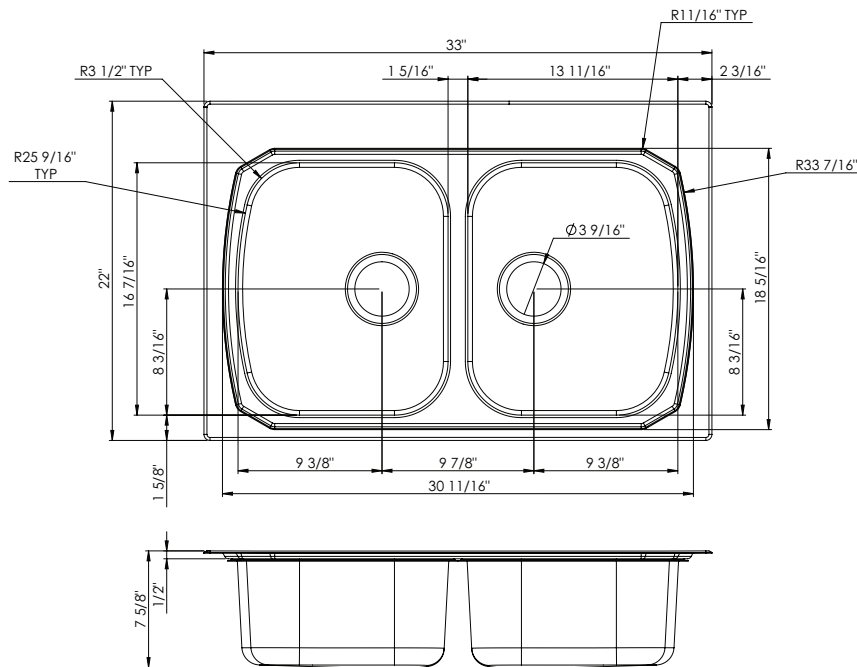

INCLUDED ACCESSORIES



AC09 Basket Waste x1



AC72W 'D' Colander



AC24 Synthetic Preparation Board

Maxi Basin 1
13 3/4 x 16 1/2 x 8" deep
6.2 Gallon Capacity

X = Faucet Holes - Faucet Tapping Guide

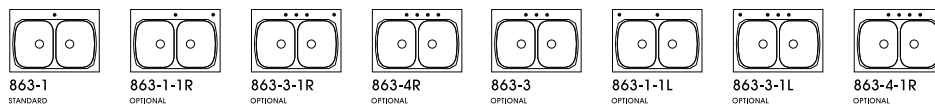

OPTIONAL ACCESSORIES



AC73



AC74



AC71



AC82

Undermount CAD files
(DXF & DWG format)
can be downloaded from
our web site
www.oliverisinks.com



Head Office and Manufacturing
Tasman Sinkware Pty Ltd
51 Naweena Rd. Regency Park
South Australia, 5010, AUSTRALIA
Tasman Sinkware

North America
1230 Railroad St
Corona CA 92882
northamerica@oliverisinks.com

Project / Customer Name: _____

Approval: _____

Date: _____